



Einbauanleitung Elektrosatz  
Anhängervorrichtung mit 12-N Steckdose  
lt. DIN/ISO Norm 1724

Instructions de montage du faisceau  
électrique pour crochet d'attelage  
conforme à la norme  
DIN/ISO 1724 prise 12-N

Fitting instructions electric wiringkit  
towbar with 12-N socket up to  
DIN/ISO norm 1724

Montage-handleiding elektrokabelset voor  
trekhaak met 12-N contactdoos  
vlgs. DIN/ISO norm 1724

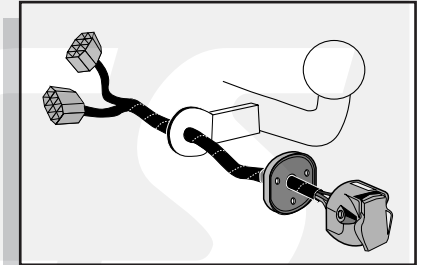

MAZDA 626 SEDAN/HATCHBACK/WAGON 2000-

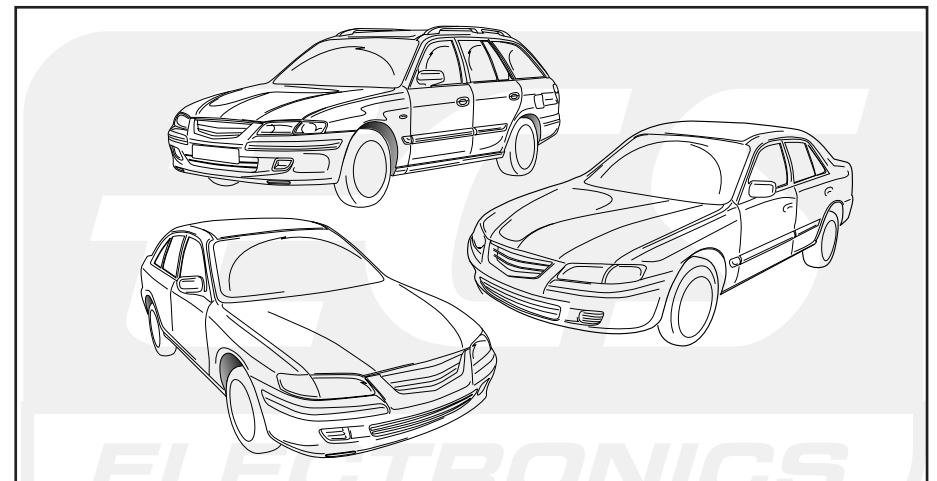

Bestel Nr.: MZ-015-BB

\*Teilliste

\*Liste de pieces

\*Part list

\*Onderdelenlijst

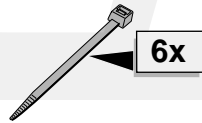
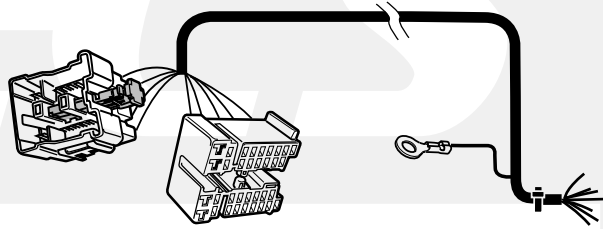
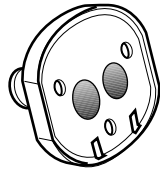
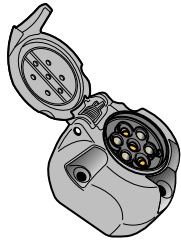
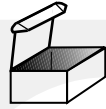

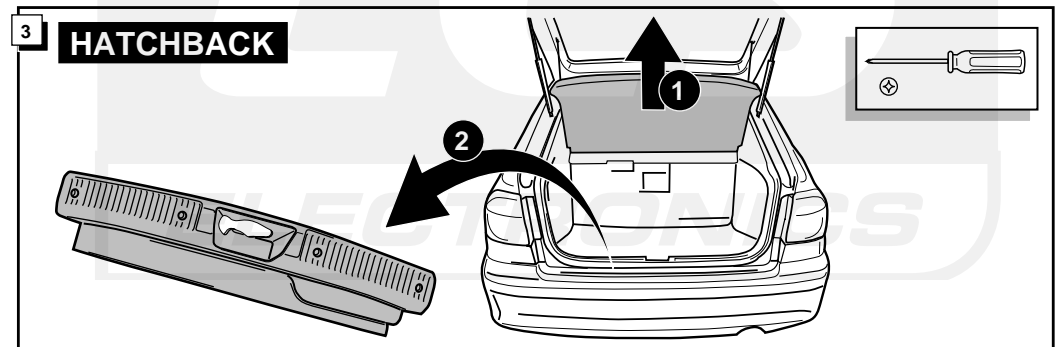
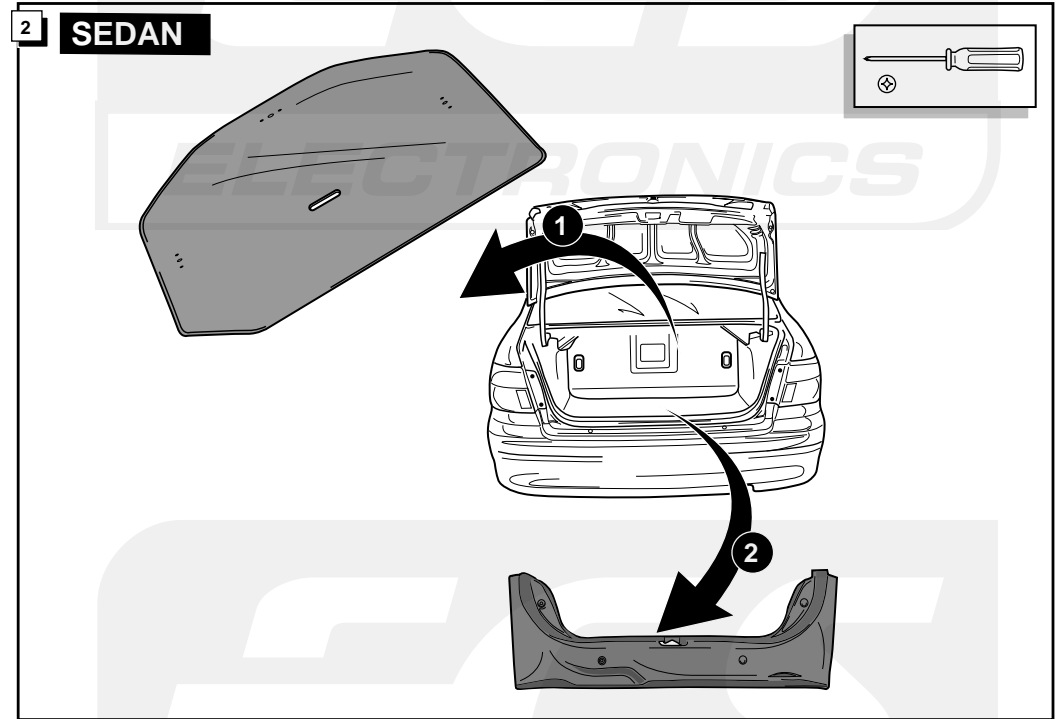
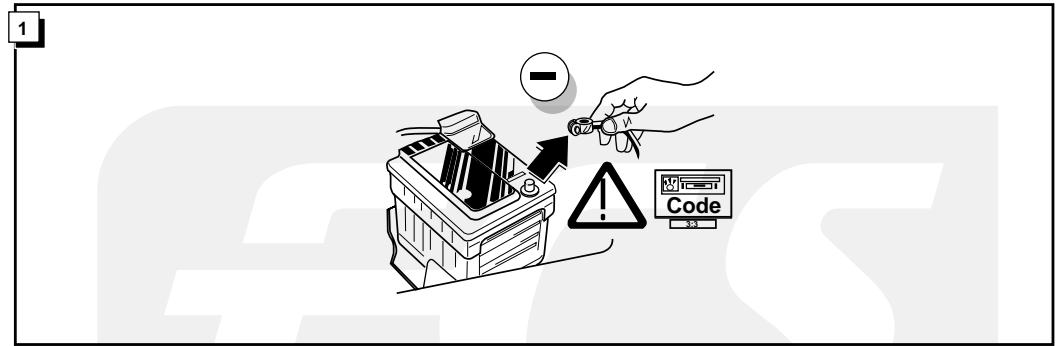

**4 WAGON**

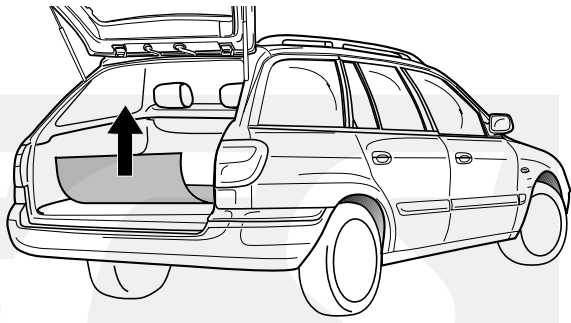

**22 HATCHBACK**

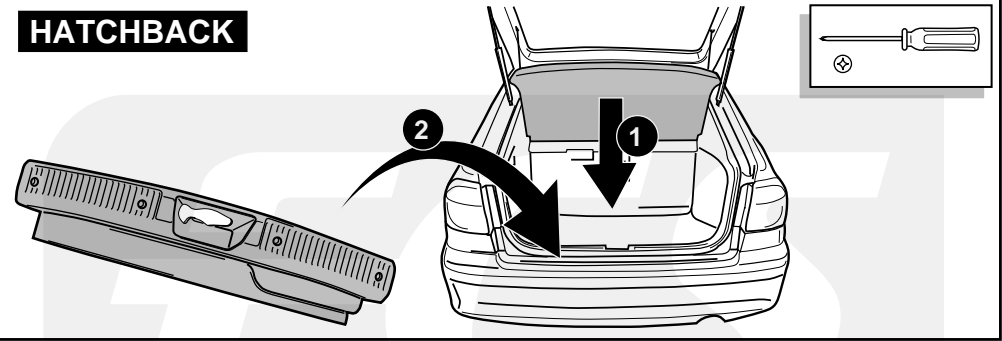

**5 WAGON**

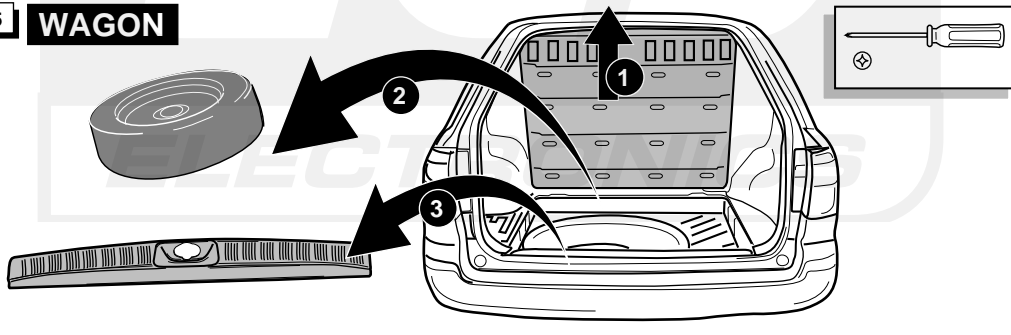

**23 WAGON**

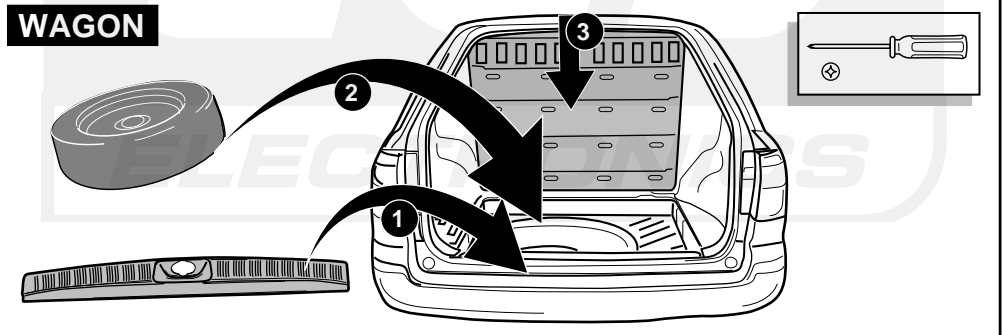

**6 SEDAN + HATCHBACK**

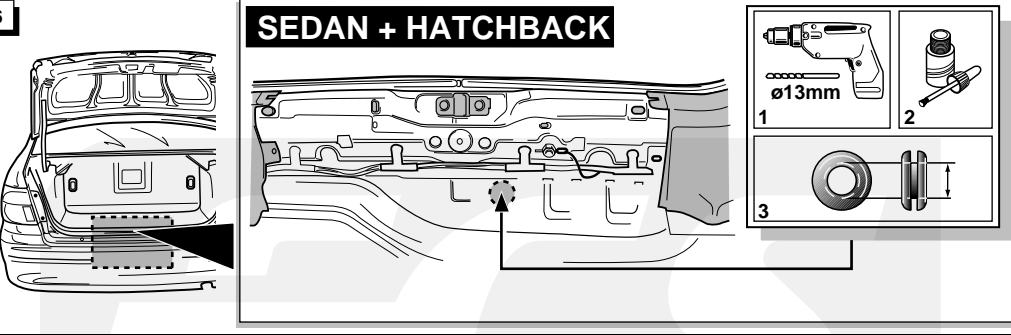

**24 WAGON**

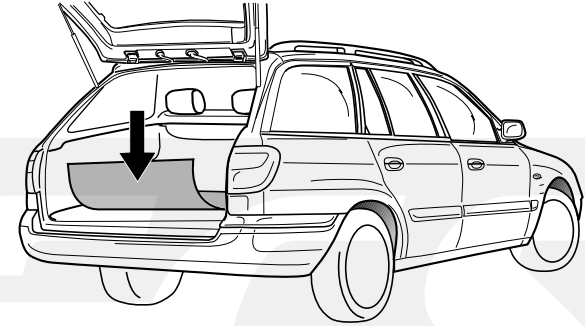

**7 WAGON**

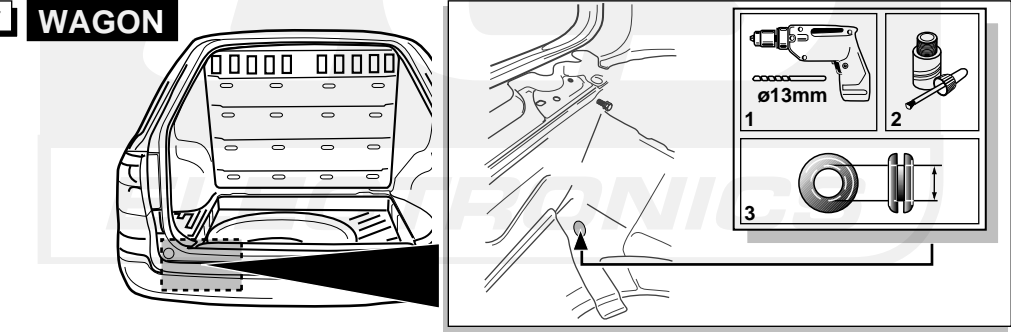

16

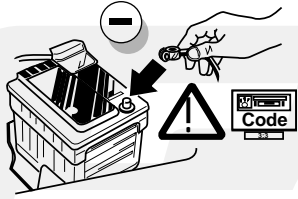

17

**!** FUNKTIONEN KONTROLLIEREN !  
 CONTRÔLER LES FONCTIONS !  
 CHECK FUNCTIONS !  
 CONTROLEER FUNCTIES !

18

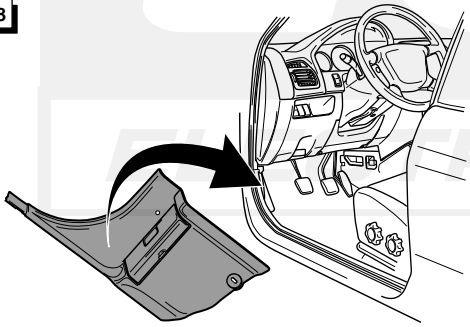

19

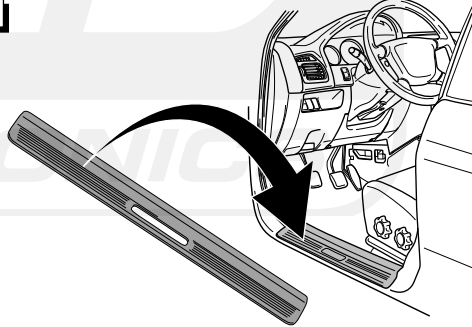

20

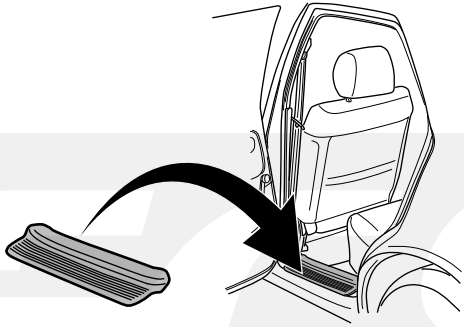

21

**SEDAN**

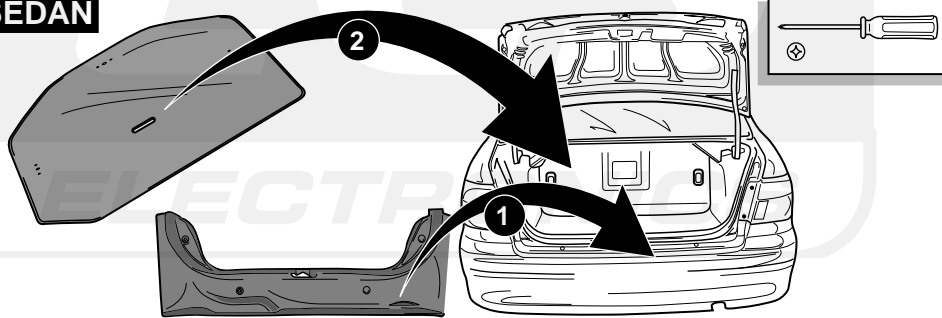

**INFO**

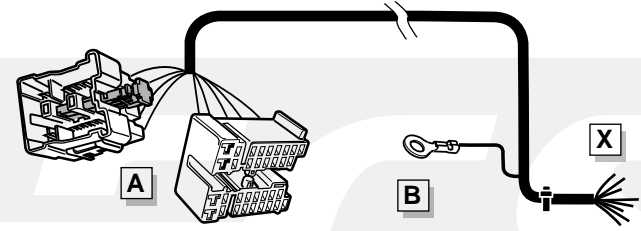

**ROUTING**

**SEDAN + HATCHBACK**

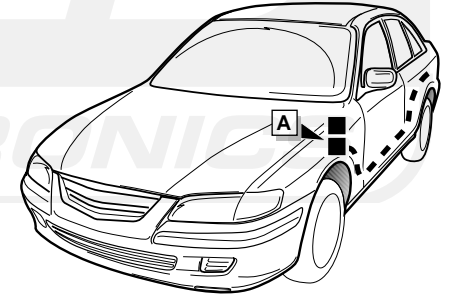
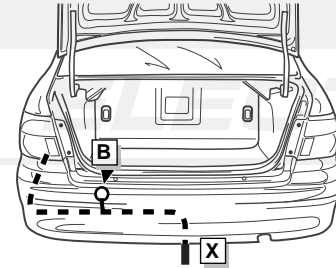

**ROUTING**

**WAGON**

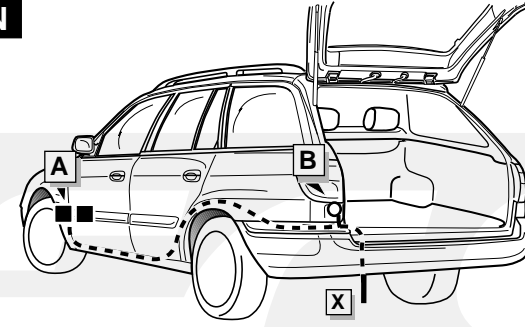

8

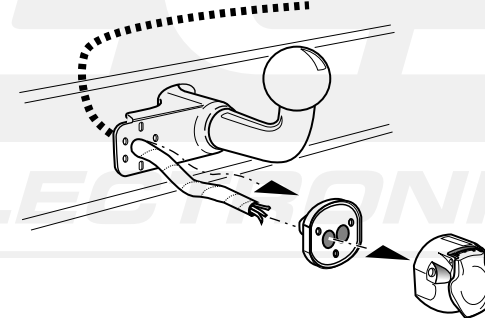

DIN/ISO 1724		D	F	GB	NL
	1/L	gelb	jaune	yellow	geel
	2	blau	bleu	blue	blauw
	1-8	weiß	blanc	white	wit
	4/R	grün	vert	green	groen
	5/58-R	braun+schwarz	marron+noir	brown+black	bruin+zwart
	6/54	rot	rouge	red	rood
	7/58-L	schwarz	noir	black	zwart
	8/58-b	grau	gris	grey	grijs

