



Einbauanleitung Elektrosatz Anhängervorrichtung
mit 12-N Steckdose
lt. DIN/ISO Norm 1724

Instructions de montage du faisceau
électrique pour crochet d'attelage
conforme à la norme
DIN/ISO 1724 prise 12-N

Fitting instructions electric wiringkit
towbar with 12-N socket up to
DIN/ISO norm 1724

Montage-handleiding elektrokabelset voor trekhaak
met 12-N contactdoos
vlg. DIN/ISO norm 1724

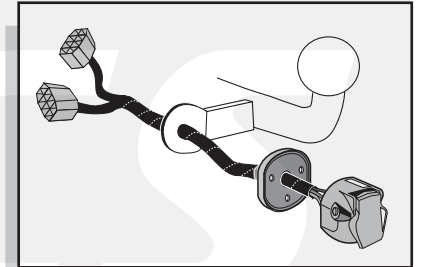

OPEL ASTRA Hatchback/Station/Sedan 1998- OPEL ZAFIRA 8/1999-

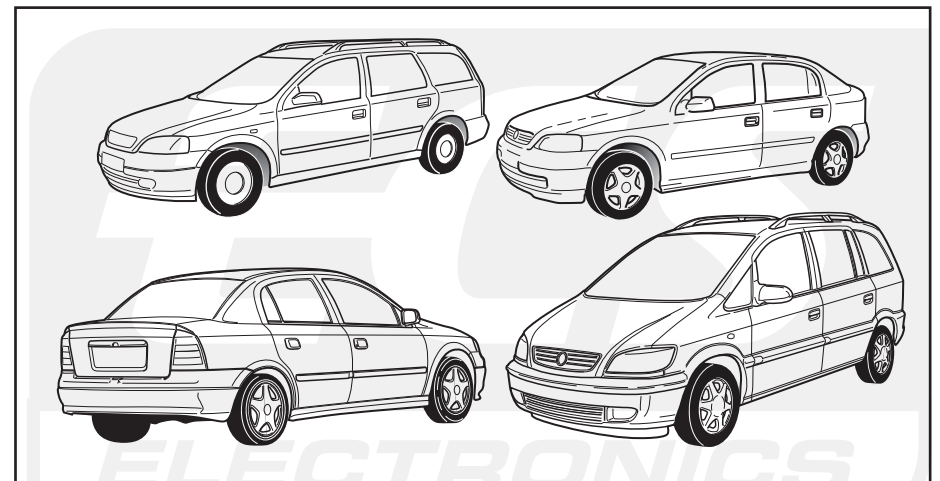

Bestel Nr.: OP-003-BB



* Teilliste * Liste de pieces * Part list * Onderdelenlijst

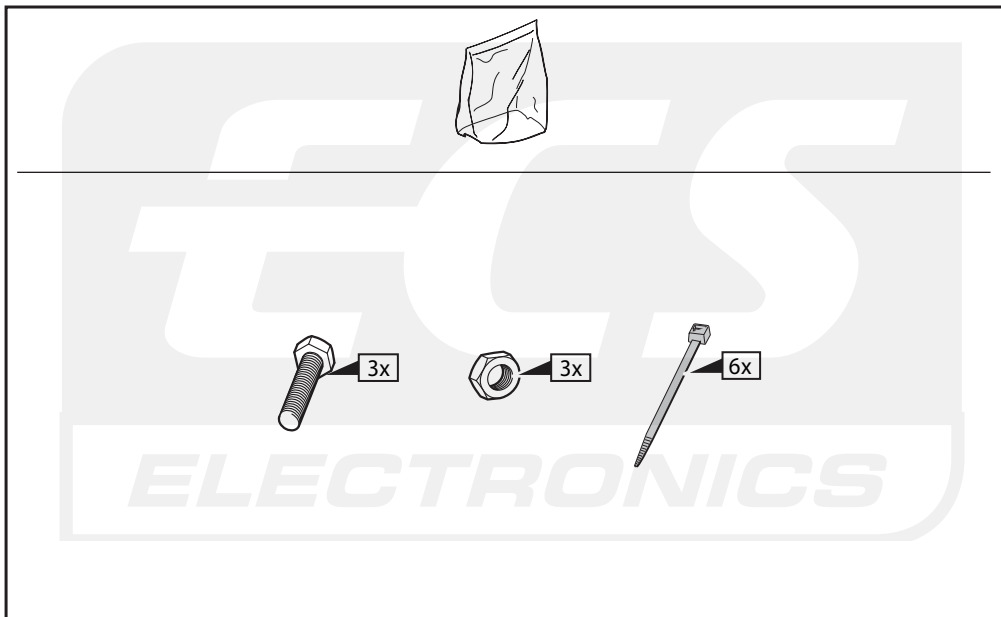
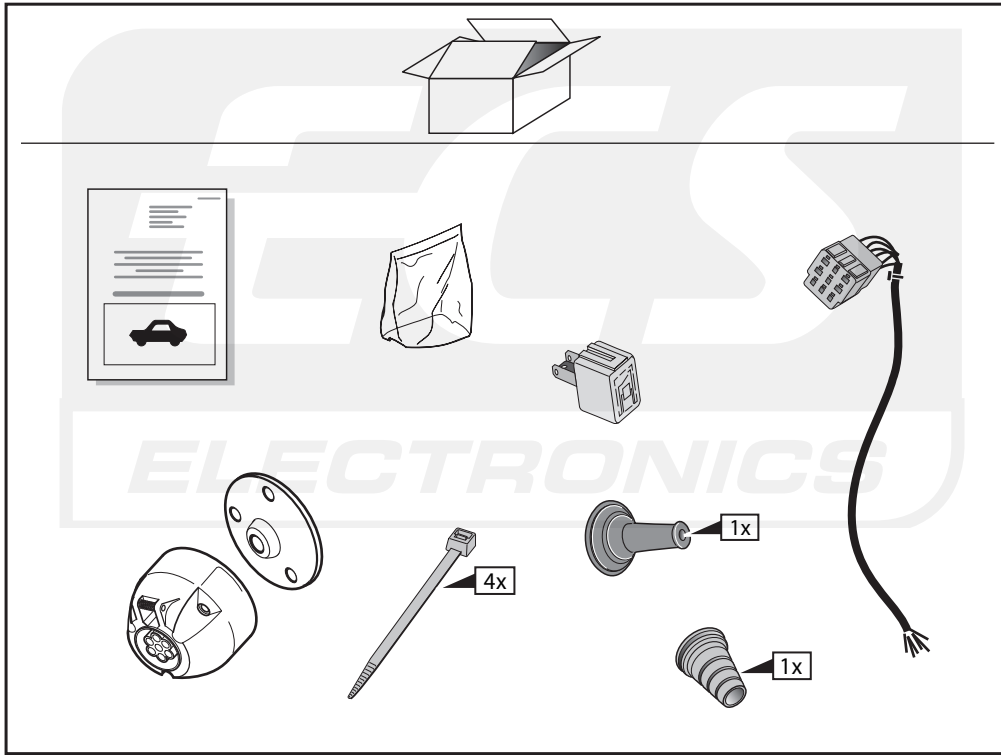

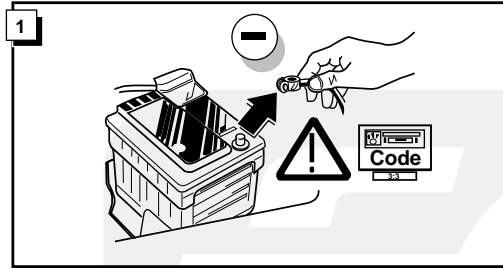

- * Für HB & SDN models sehen Sie Seite 4 bis 7
- * Pour HB & SDN models voir page 4 à 7
- * For HB & SDN models see page 4 to 7
- * Voor HB & SDN modellen zie pagina 4 tot 7

- ** OPEL ZAFIRA ab Seite 7
- ** OPEL ZAFIRA de page 7
- ** OPEL ZAFIRA from page 7
- ** OPEL ZAFIRA vanaf pagina 7

STATION

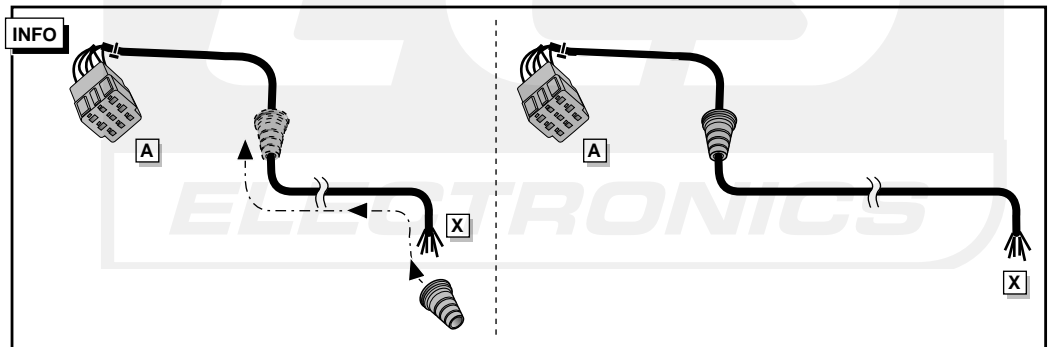
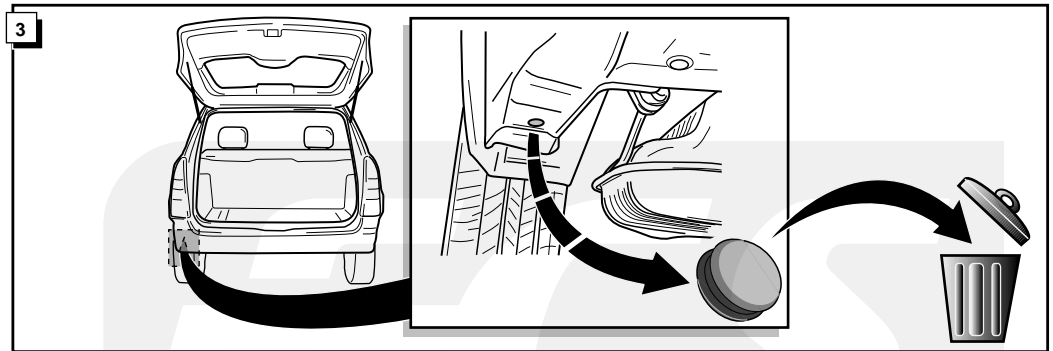
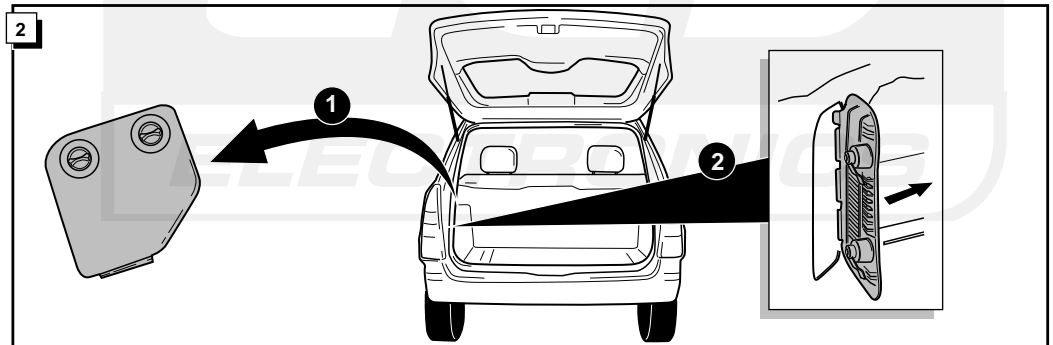

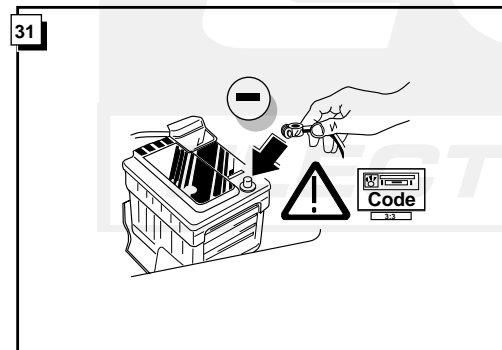
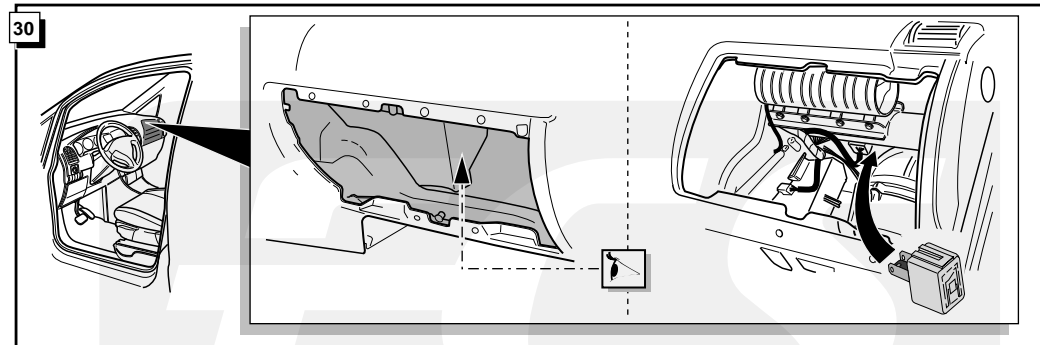
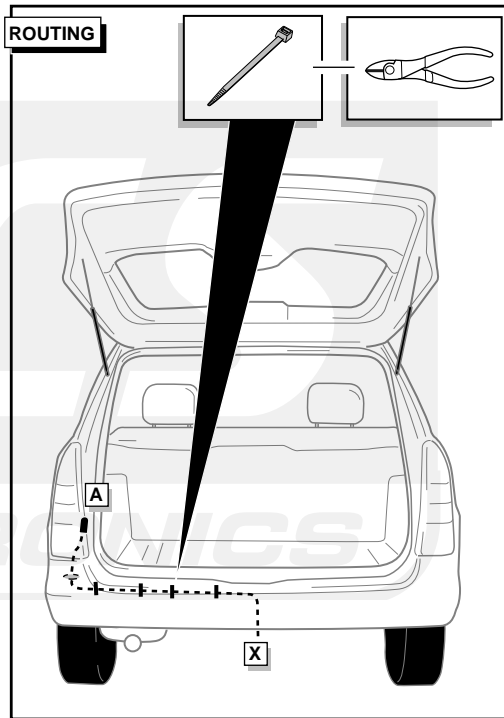
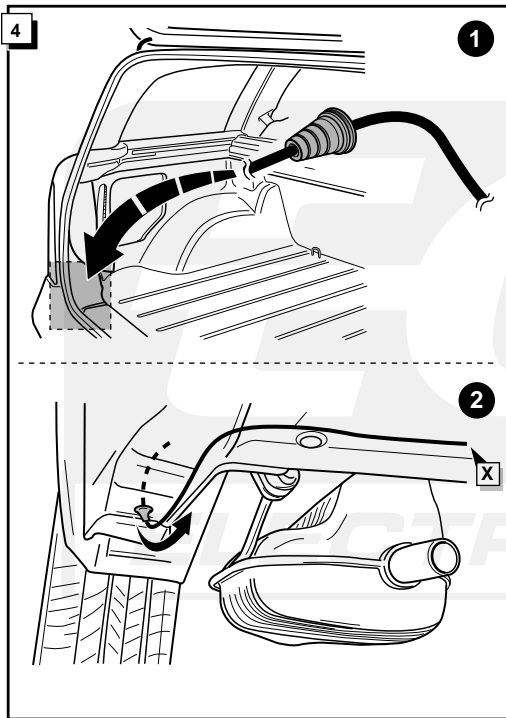

32

FUNKTIONEN KONTROLIEREN !
CONTRÔLER LES FONCTIONS !
CHECK FUNCTIONS !
CONTROLEER FUNCTIES !

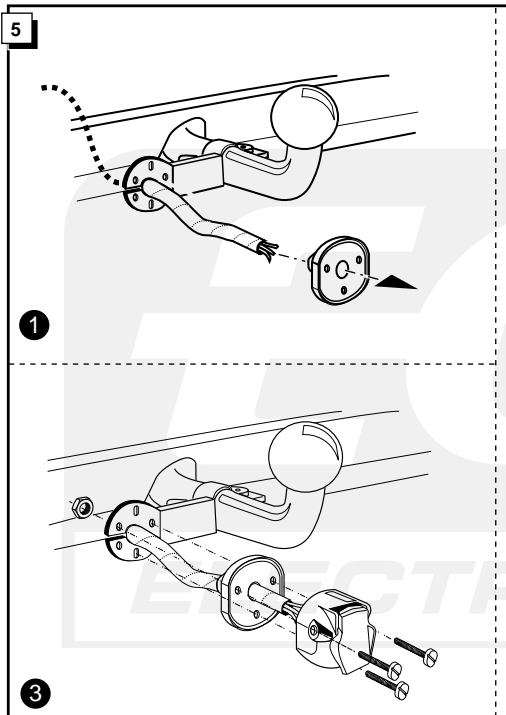

	(D)	(FR)	(GB)	(NL)
1 = L	GELB	JAUNE	YELLOW	GEEL
2 = 54-G	BLAU	BLEU	BLUE	BLAUW
3 = 31	WEIß	BLANC	WHITE	WIT
4 = R	GRÜN	VERT	GREEN	GROEN
5 = 58-R	BRAUN	MARRON	BROWN	BRUIN
6 = 54	ROT	ROUGE	RED	ROOD
7 = 58-L	SCHWARZ	NOIR	BLACK	ZWART
8 = 58-B	GRAU	GRIS	GREY	GRIS

33

6x

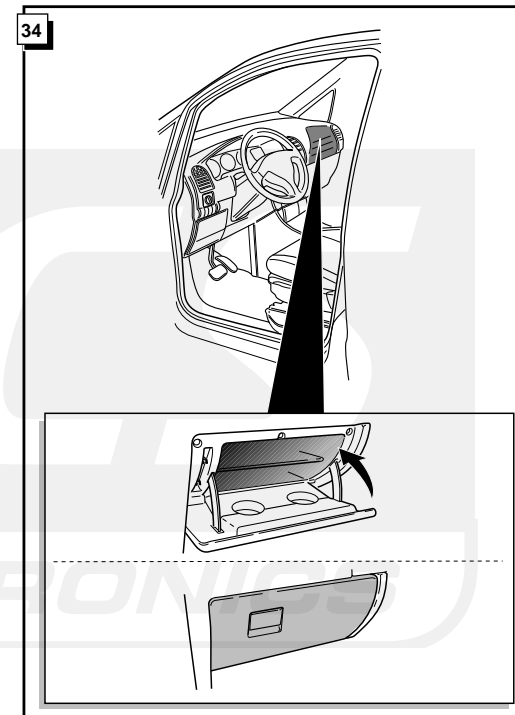

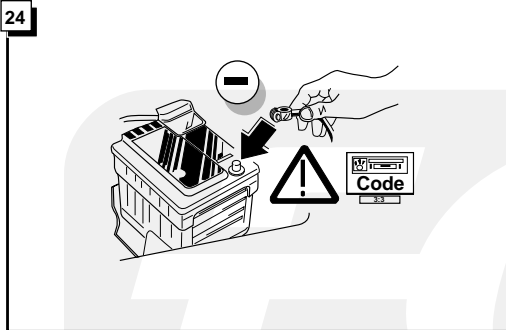

25

! FUNKTIONEN KONTROLIEREN !
! CONTRÔLER LES FONCTIONS !
! CHECK FUNCTIONS !
! CONTROLEER FUNCTIES !

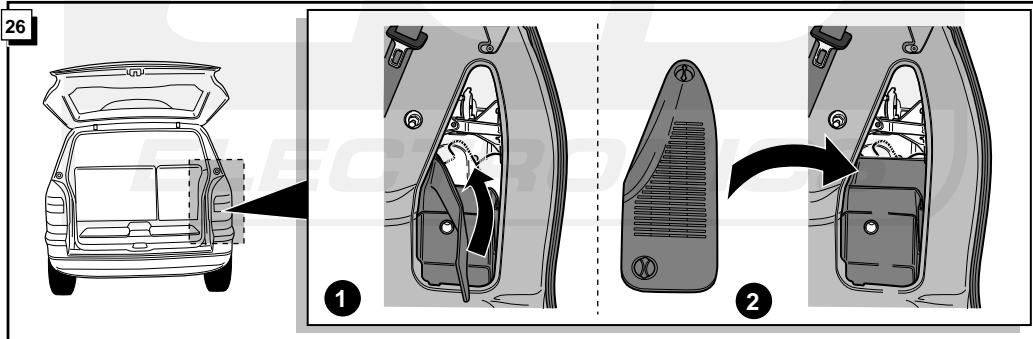

OPEL ASTRA STATION / HATCHBACK / SEDAN - OPEL ZAFIRA

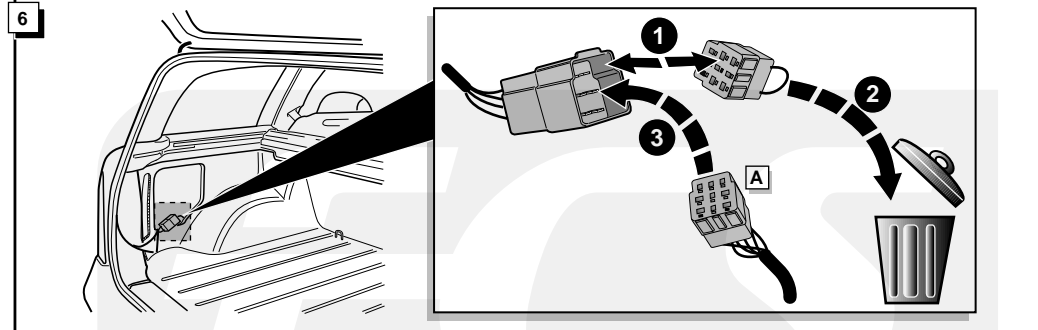
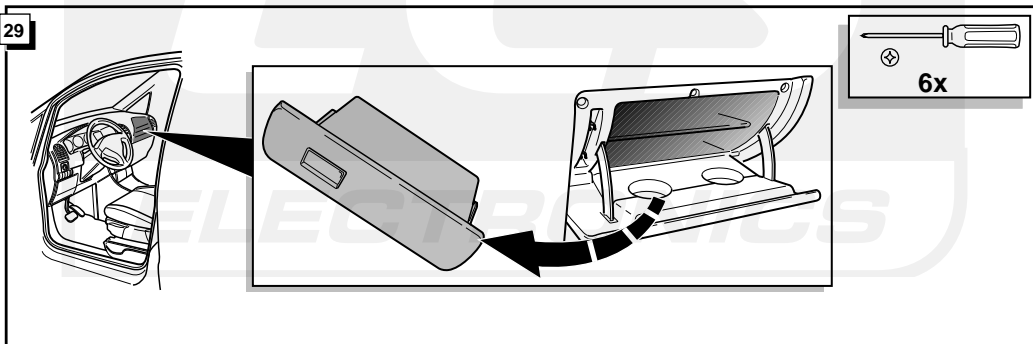
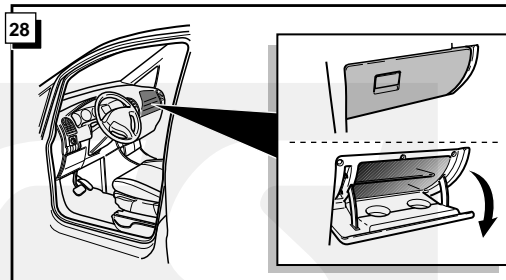
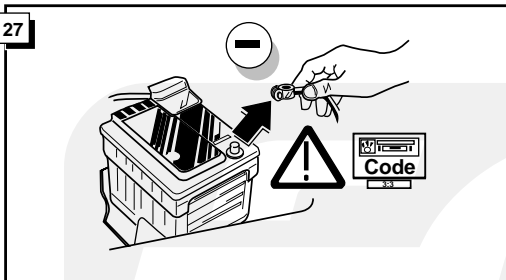

** Fig. 27 bis 34 ist nur für Modellen mit check control für die Bremsleuchten.
 ** Fig. 27 à 34 est seul pour models avec check control des feux de stop.
 ** Fig. 27 to 34 only for models with check control for the breaklights.
 ** Fig. 27 tot 34 is alleen voor de modellen met check control voor de remlichten.

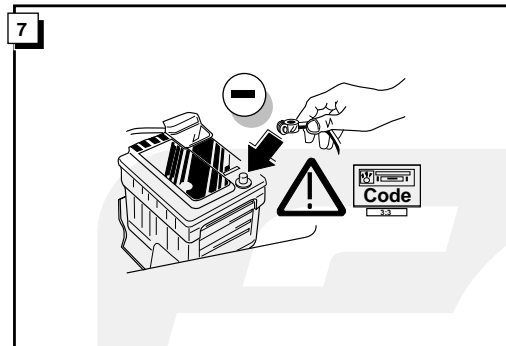

8

! FUNKTIONEN KONTROLIEREN !
! CONTRÔLER LES FONCTIONS !
! CHECK FUNCTIONS !
! CONTROLEER FUNCTIES !

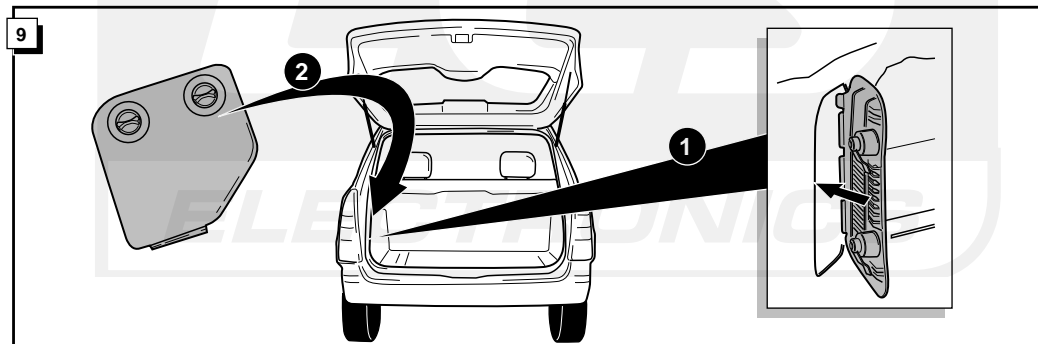

HATCHBACK & SEDAN

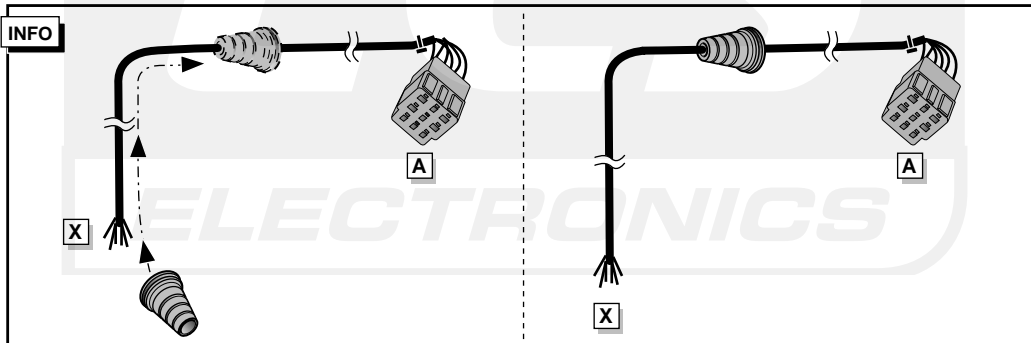
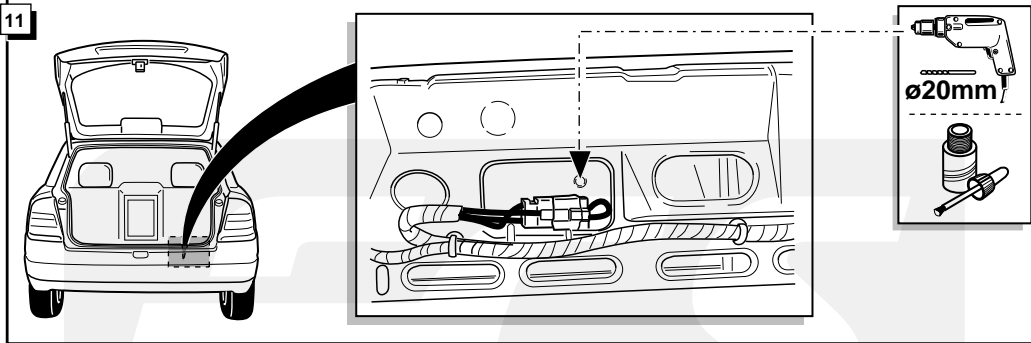
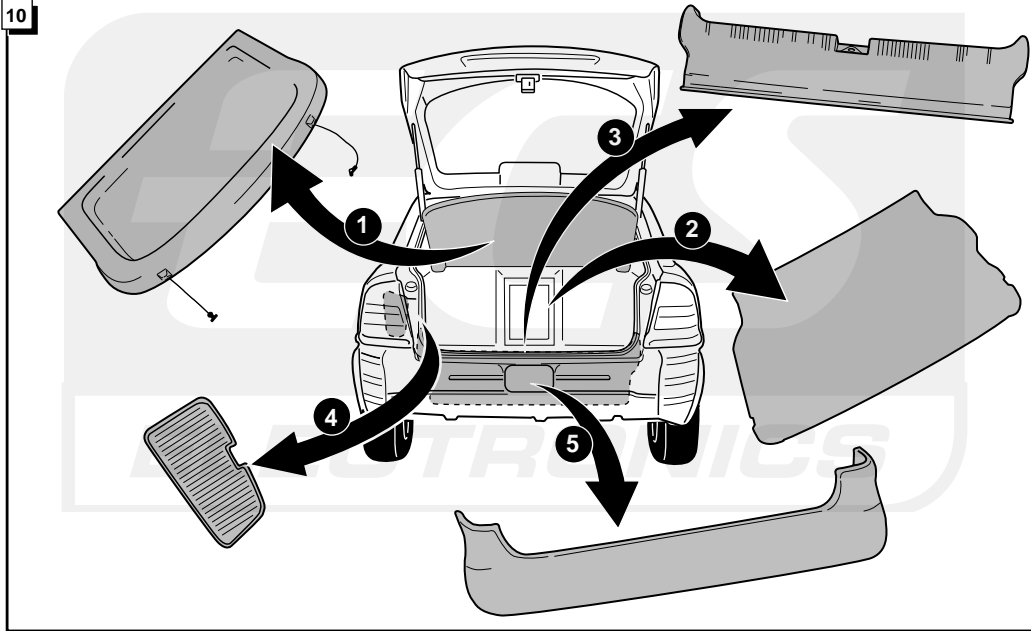

	(D)	(FR)	(GB)	(NL)
1 = L	GELB	JAUNE	YELLOW	GEEL
2 = 54-G	BLAU	BLEU	BLUE	BLAUW
3 = 31	WEIß	BLANC	WHITE	WIT
4 = R	GRÜN	VERT	GREEN	GROEN
5 = 58-R	BRAUN	MARRON	BROWN	BRUIN
6 = 54	ROT	ROUGE	RED	ROOD
7 = 58-L	SCHWARZ	NOIR	BLACK	ZWART
8 = 58-B	GRAU	GRIS	GREY	GRIJS

BLINKER LINKS
 CLIGNOTANT GAUCHE
 L.H. INDICATOR
 KNIPPERLICHT LINKS

BLINKER RECHTS
 CLIGNOTANT DROIT
 R.H. INDICATOR
 KNIPPERLICHT RECHTS

MASSE
 MASSE
 EARTH
 MASSA

STOP
 BREMSLEUCHE
 FEUX DE STOP
 BRAKELICHTS
 REMLICHTEN

SCHLÜBLEUCHE LINKS
 FEU ARRIERE GAUCHE
 L.H. REARLIGHT
 ACHTERLICHT LINKS

SCHLÜBLEUCHE RECHTS
 FEU ARRIERE DROIT
 R.H. REARLIGHT
 ACHTERLICHT RECHTS

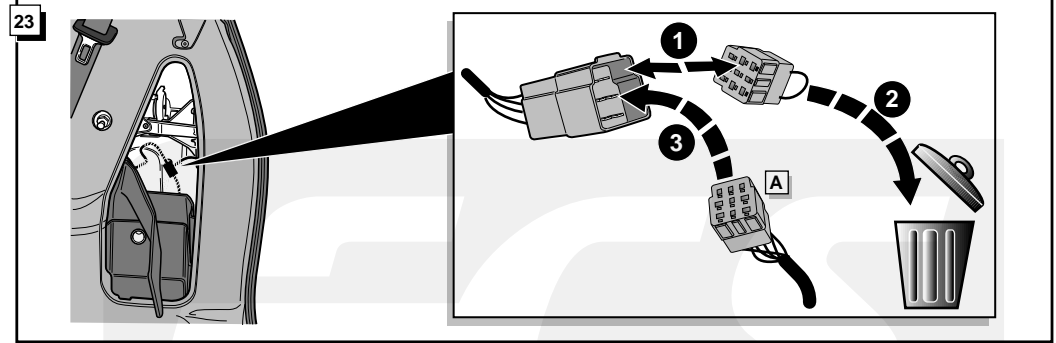

- ** Fig. 27 bis 34 ist nur für Modellen mit check control für die Bremsleuchten.
- ** Fig. 27 à 34 est seul pour models avec check control des feux de stop.
- ** Fig. 27 to 34 only for models with check control for the breaklights.
- ** Fig. 27 tot 34 is alleen voor de modellen met check control voor de remlichten.

20

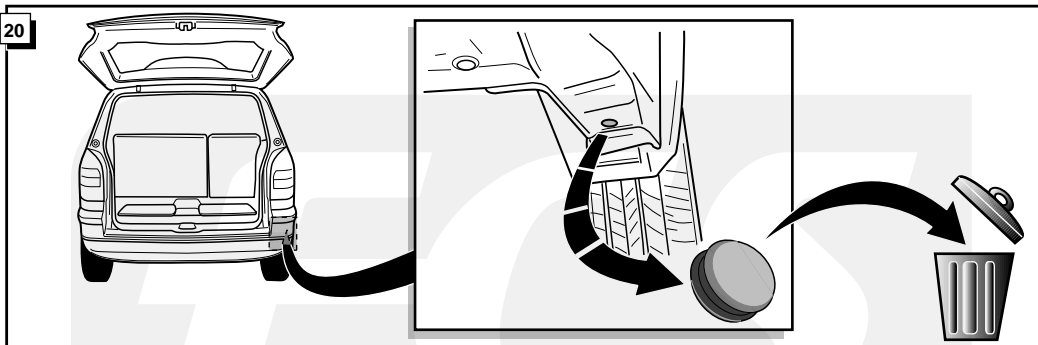

INFO

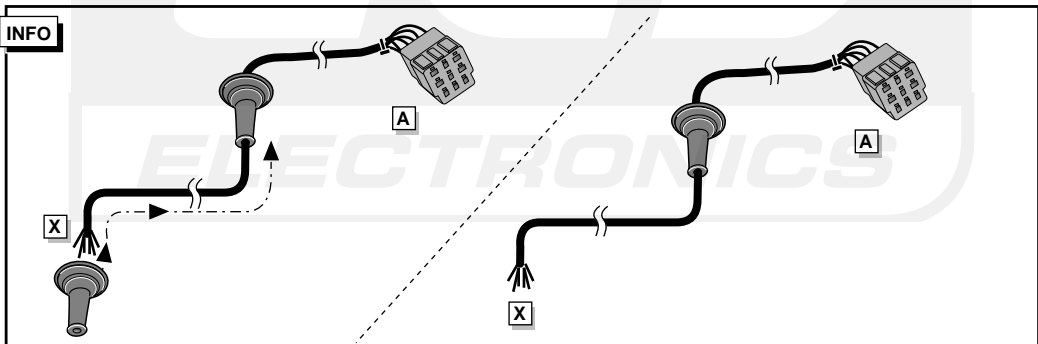

21

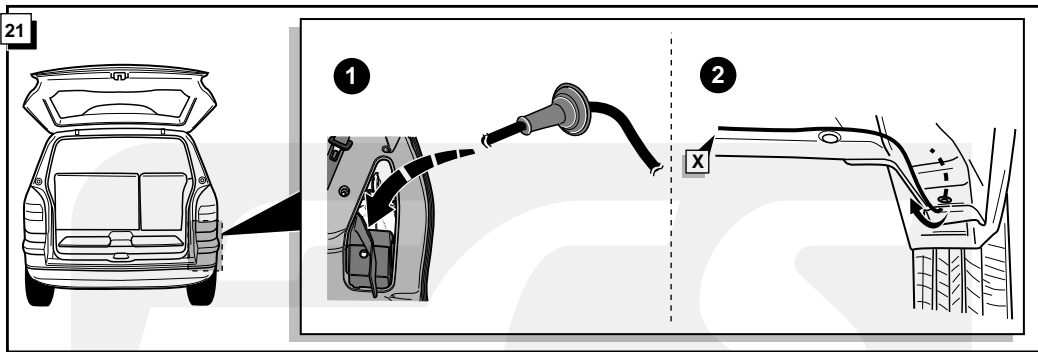

ROUTING

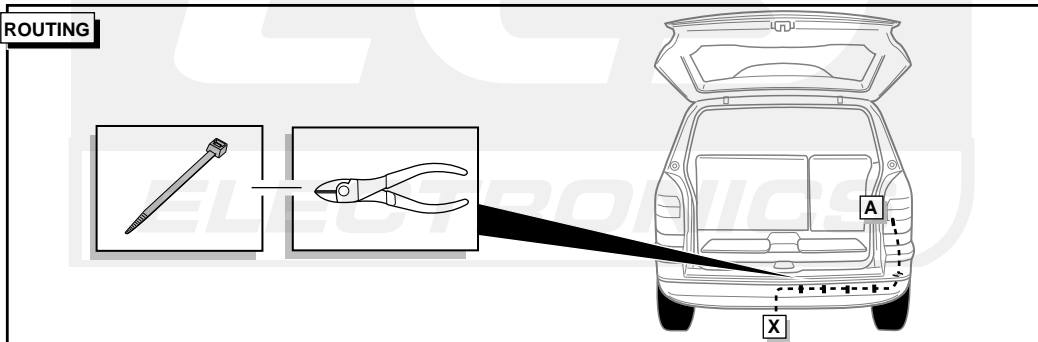

ROUTING

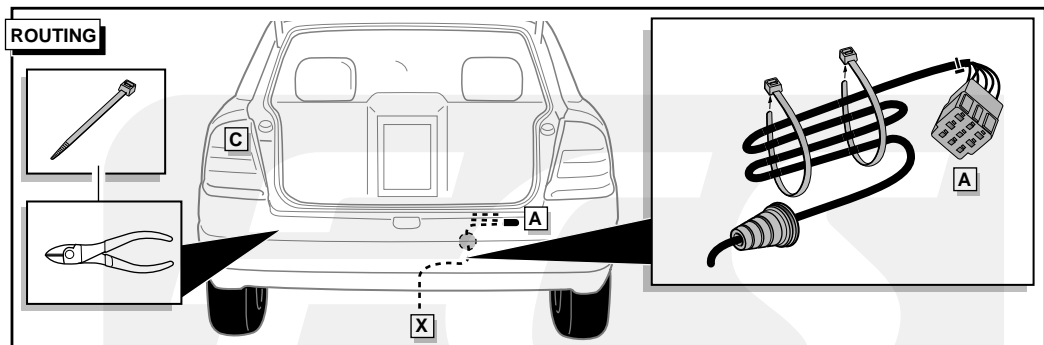

12

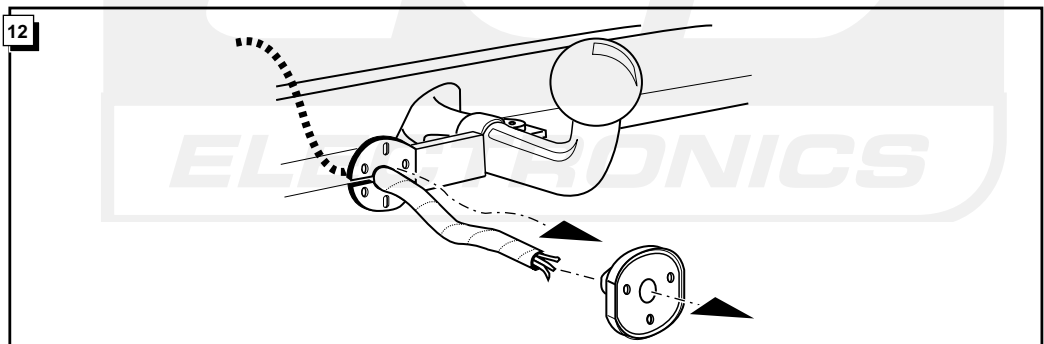

13

BLINKER LINKS
 CLIGNOTANT GAUCHE
 L.H. INDICATOR
 KNIPPERLICHT LINKS

BREMSLEUCHE
 FEUX DE STOP
 BRAKELICHTS
 REMLICHTEN

STOP

SCHLUßLEUCHE LINKS
 FEU ARRIERE GAUCHE
 L.H. REARLIGHT
 ACHTERLICHT LINKS

BLINKER RECHTS
 CLIGNOTANT DROIT
 R.H. INDICATOR
 KNIPPERLICHT RECHTS

SCHLUßLEUCHE RECHTS
 FEU ARRIERE DROIT
 R.H. REARLIGHT
 ACHTERLICHT RECHTS

	(D)	(FR)	(GB)	(NL)
1 = L	GELB	JAUNE	YELLOW	GEEL
2 = 54-G	BLAU	BLEU	BLUE	BLAUW
3 = 31	WEIß	BLANC	WHITE	WIT
4 = R	GRÜN	VERT	GREEN	GROEN
5 = 58-R	BRAUN	MARRON	BROWN	BRUIN
6 = 54	ROT	ROUGE	RED	ROOD
7 = 58-L	SCHWARZ	NOIR	BLACK	ZWART
8 = 58-B	GRAU	GRIS	GREY	GRIJS

MASSE
 EARTH
 MASSA

14



- ** Fig. 27 bis 34 ist nur für Modellen mit check control für die Bremsleuchten.
- ** Fig. 27 à 34 est seul pour models avec check control des feux de stop.
- ** Fig. 27 to 34 only for models with check control for the breaklights.
- ** Fig. 27 tot 34 is alleen voor de modellen met check control voor de remlichten.

15

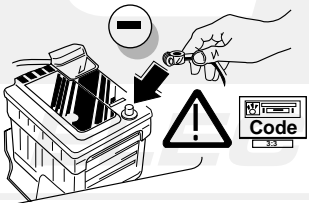

16

! FUNKTIONEN KONTROLIEREN !
 CONTRÔLER LES FONCTIONS !
 CHECK FUNCTIONS !
 CONTROLEER FUNCTIES !

17

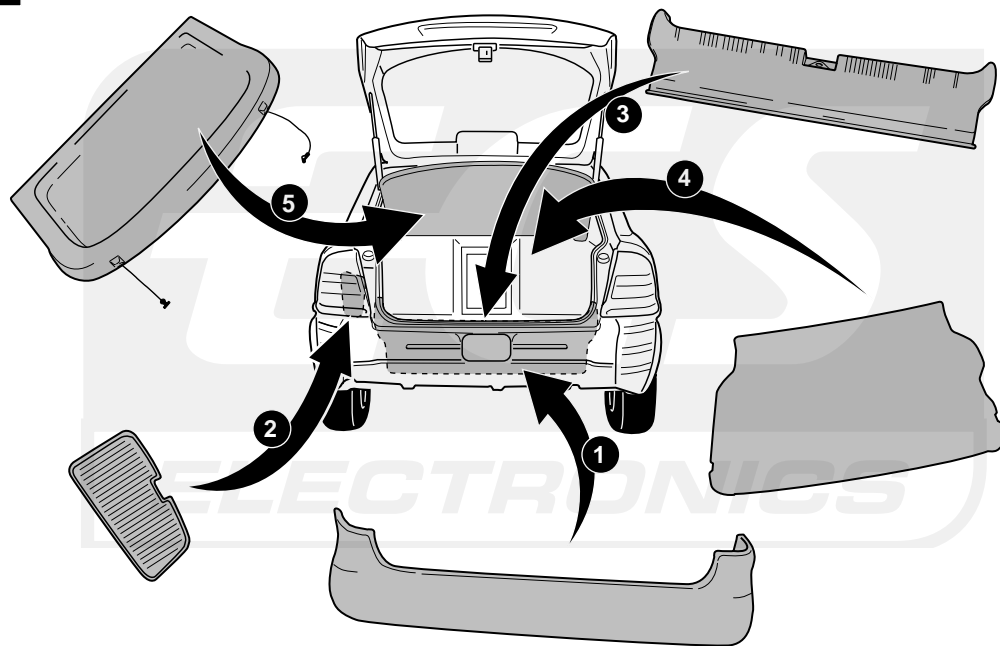

OPEL ZAFIRA

18

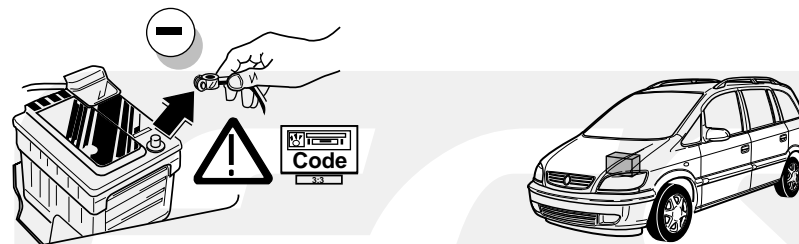

19

