

BM91752H: FITTING ADVICE

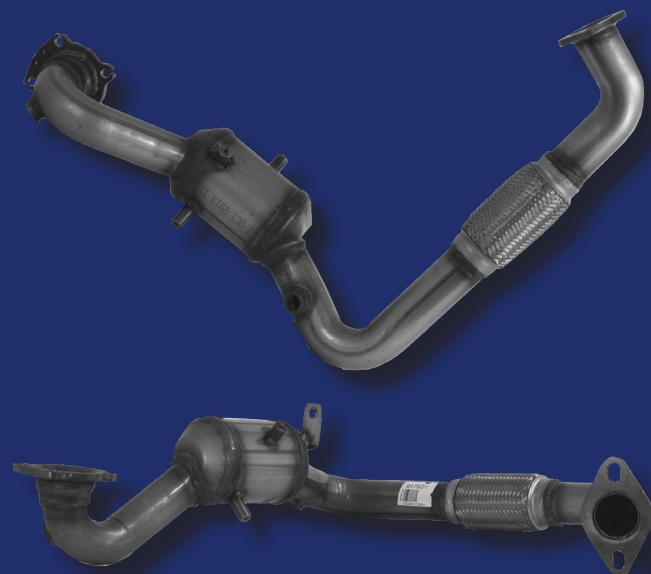

- Once the old unit has been removed from the vehicle, ensure that all contacting surfaces are clean and that all traces of the old gaskets are removed from the turbo and centre section in order to create a tight seal. Failure to do so could result in an exhaust leak.
- Before installing the new unit to the vehicle, ensure that you refit the heatshields from the old unit onto the new unit. It will not be possible to refit these once the unit has been fitted to the vehicle.
- With the heatshields in place, use new gaskets to install the replacement unit. Ensure you do this loosely to begin with (starting at the front) to allow some movement so that the support bracket can be bolted to the engine block.
- Once the unit is lined up and correctly in position, tighten the fittings from the front of the system backwards where appropriate, ensuring the bracket connected to the engine block is tight.
- When refitting the lambda sensor, take care to ensure that the wires are not twisted.

FITTINGS

Optional (at cost):

FK91752A
x1 front gasket
x1 rear gasket



FK91752B
x1 front gasket
x1 rear gasket
x2 rear washers
x2 rear nuts
x2 rear bolts
x4 front nuts



Please note:

The appearance of this unit differs slightly from that of the OE