

Einbauanleitung Elektrosatz  
Anhängervorrichtung mit 12-N Steckdose  
lt. DIN/ISO Norm 1724

Instructions de montage du faisceau  
électrique pour crochet d'attelage  
conforme à la norme  
DIN/ISO 1724 prise 12-N

Fitting instructions electric wiringkit  
towbar with 12-N socket up to  
DIN/ISO norm 1724

Montage-handleiding elektrokabelset voor  
trekhaak met 12-N contactdoos  
vlgs. DIN/ISO norm 1724

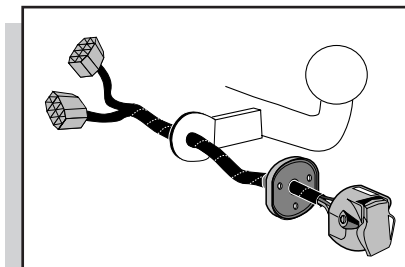

## OPEL ASTRA STATION 1998-

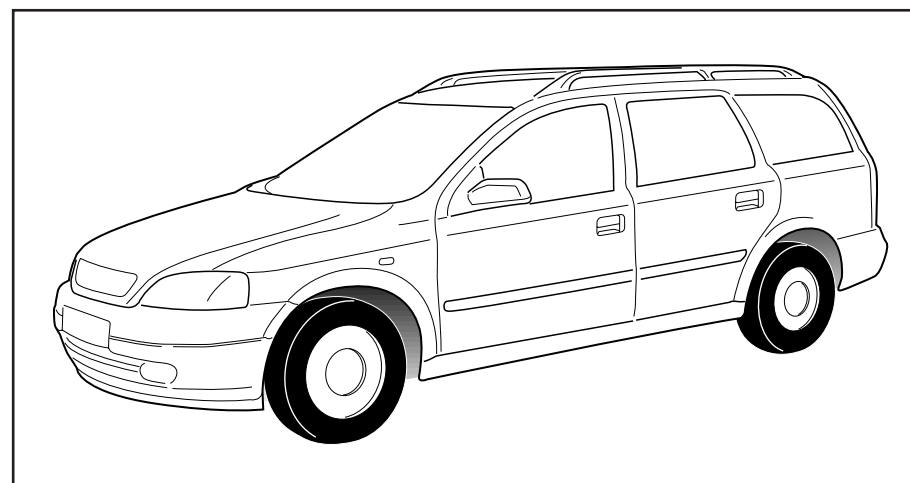

Bestel Nr.: OP-015-BB



1

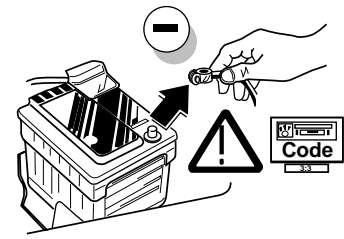

2

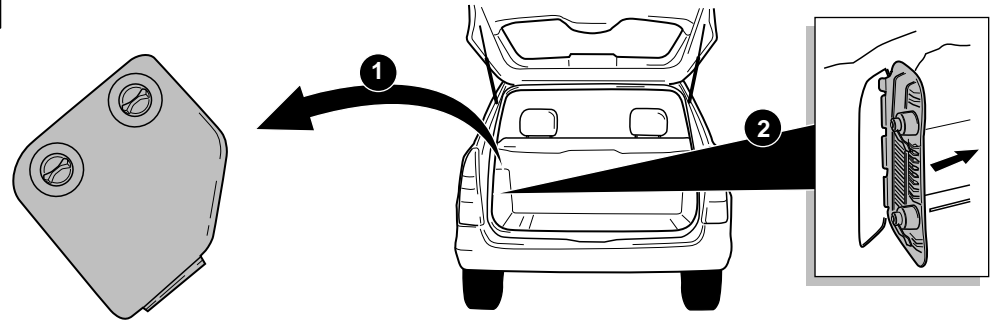

3

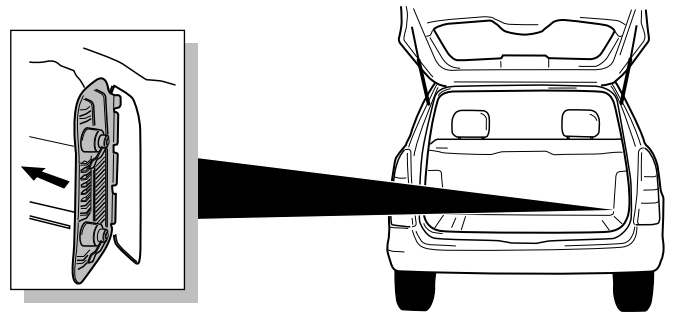

4

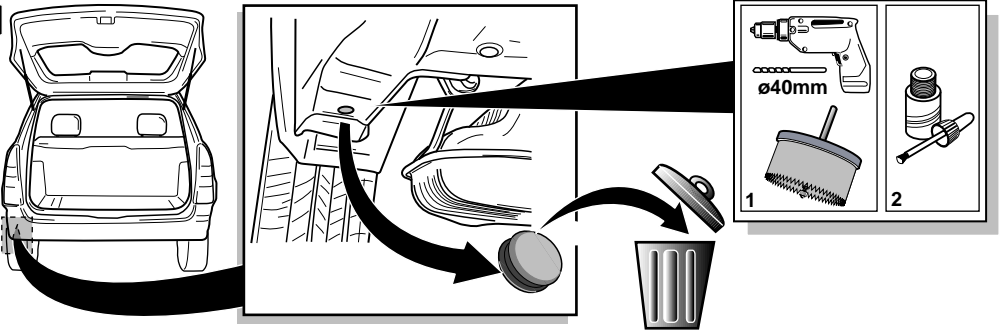

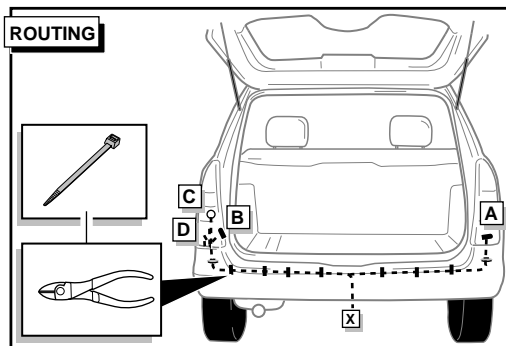
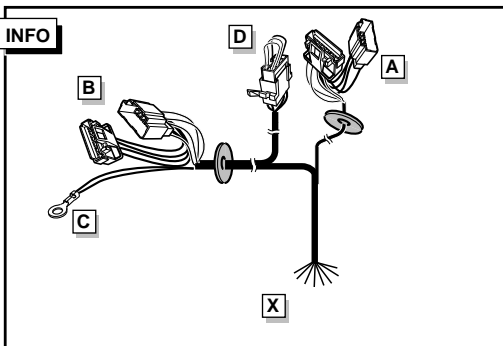
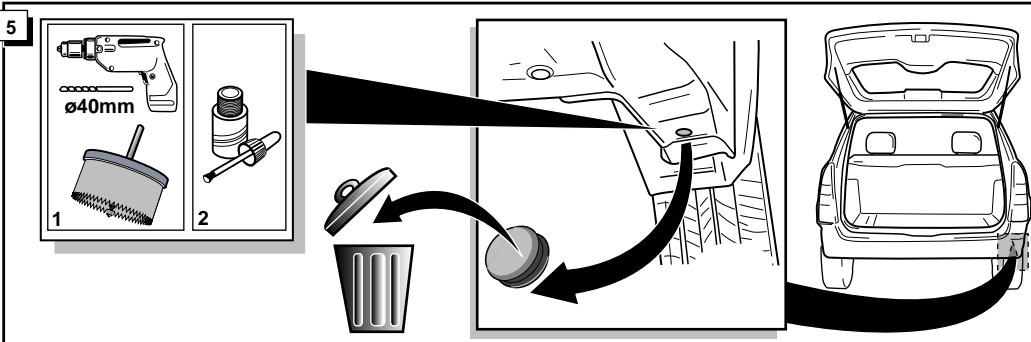

INFO Anschluß Steckdose / Connection de la prise / Socket connection / Contactdoos aansluiting

DIN/ISO 1724		(D)	(F)	(GB)	(NL)
	1/L	gelb	jaune	yellow	geel
	2	blau	bleu	blue	blauw
	3/31	weiß	blanc	white	wit
	4/R	grün	vert	green	groen
	5/58-R	braun	marron	brown	bruin
	6/54	rot	rouge	red	rood
	7/58-L	schwarz	noir	black	zwart
	8/58-b	grau	gris	grey	grijs

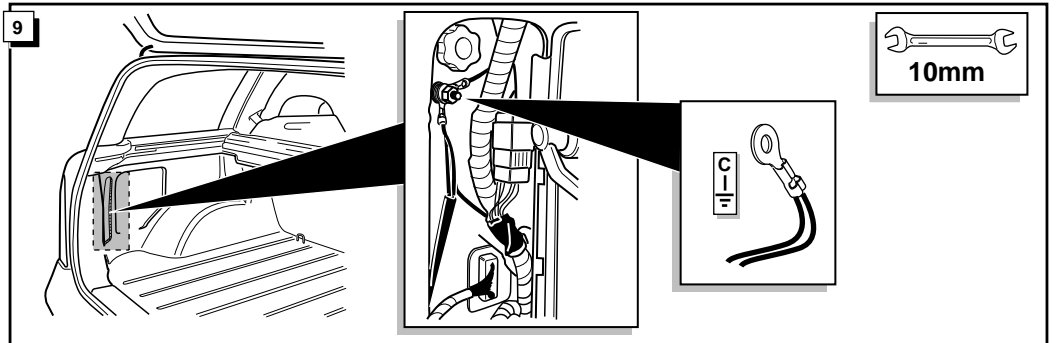
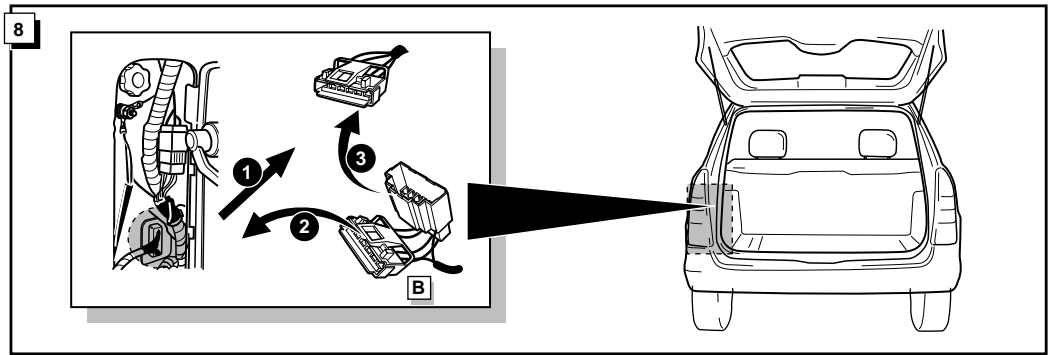
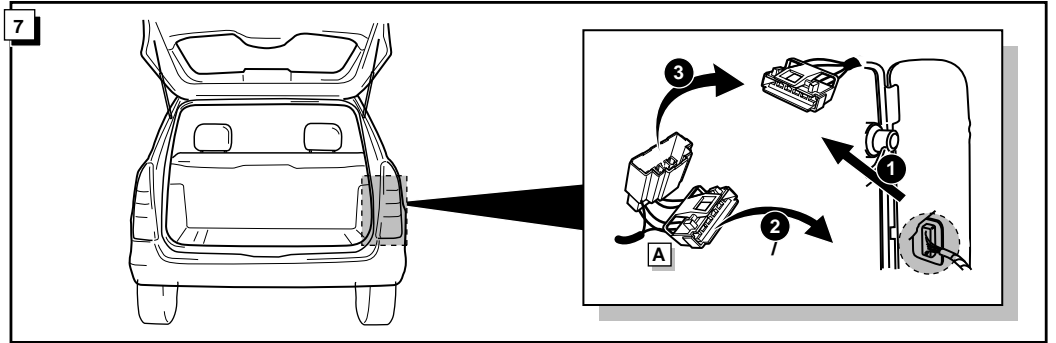
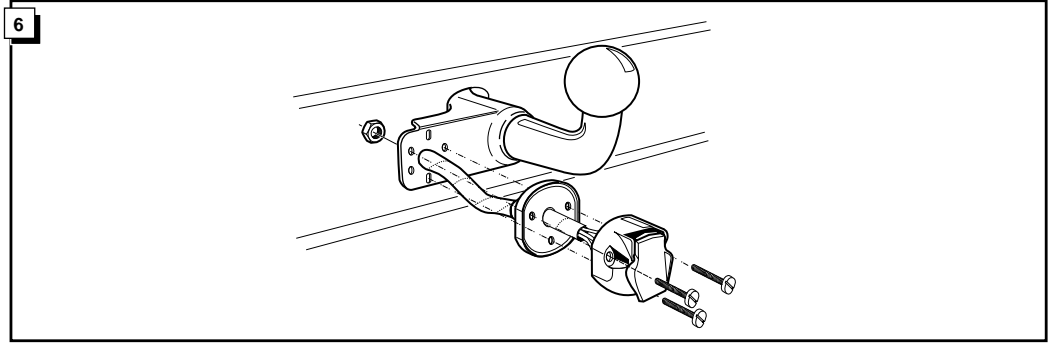
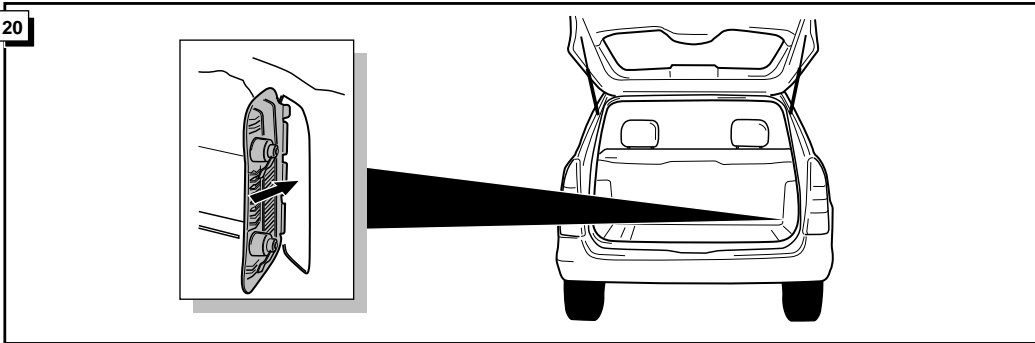
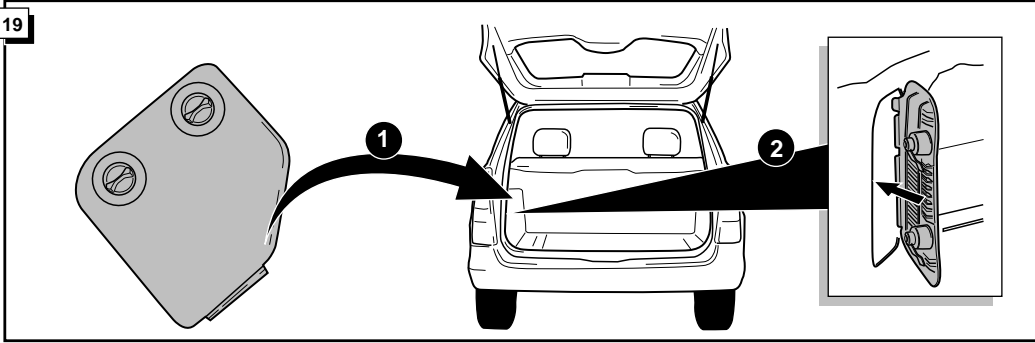

**INFO**

\* Fahrzeuge mit check control: bei Abbildung 10 weitergehen.  
Fahrzeuge ohne check control: bei Abbildung 17 weitergehen.

\* Véhicules avec check control: continuez chez figure 10.  
Véhicules sans check control: continuez chez figure 17.

\* Vehicles with check control: continue at picture 10.  
Vehicles without check control: continue at picture 17.

\* Voertuigen met check control: ga verder bij afbeelding 10.  
Voertuigen zonder check control: ga verder bij afbeelding 17.

**10**

\* **Mit Check control:** bei ihrem Lieferanten nach einem Erweiterungssatz informieren.

\* **Avec check control:** Informez chez votre fournisseur pour un faisceau d'extension.

\* **With check control:** contact your supplier for an extension kit.

\* **Met check control:** informeer bij uw leverancier naar een uitbreidingsset.

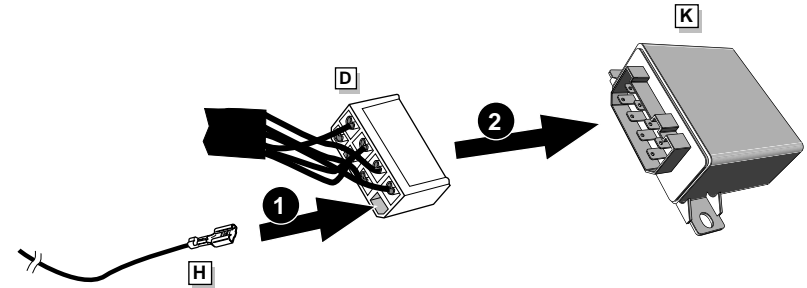
**13****INFO**

Erweiterungssatz für Fahrzeuge mit Check Control.

Faisceau d'extension pour véhicules avec check control.

Extension kit for vehicles with check control.

Uitbreidingsset voor voertuigen met check control.

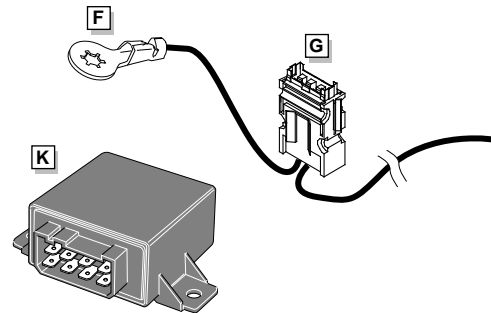
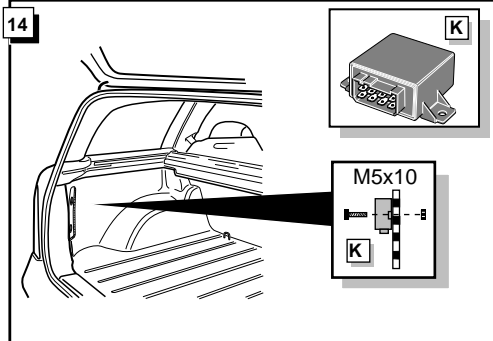
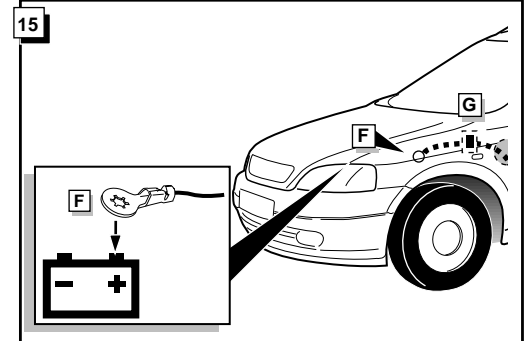
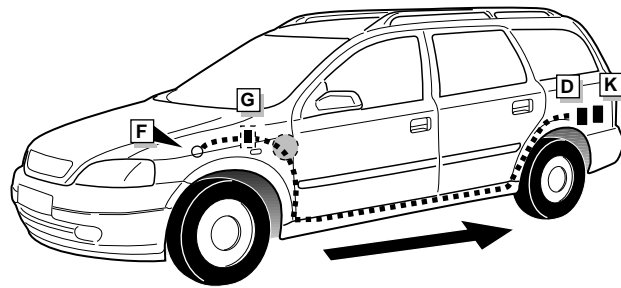
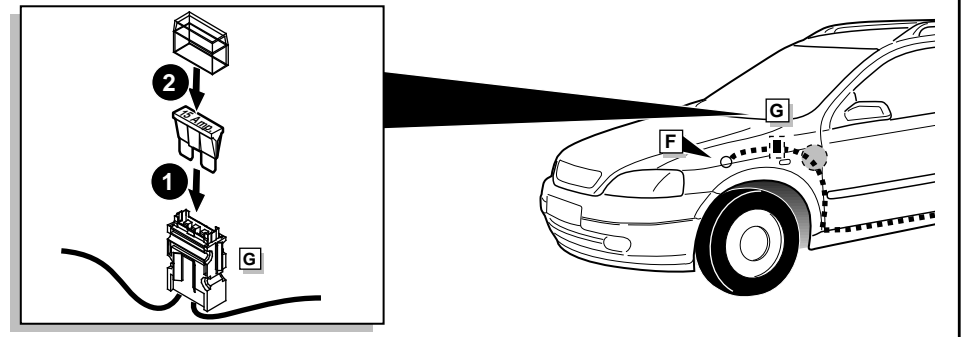
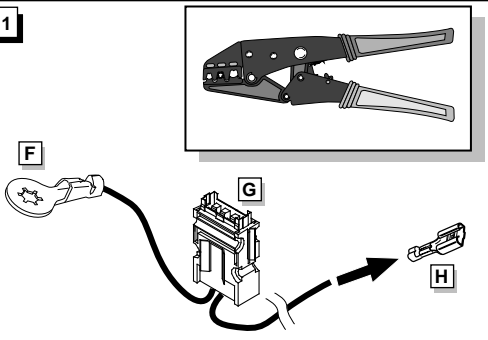
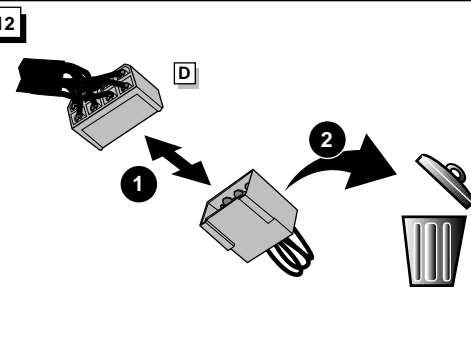
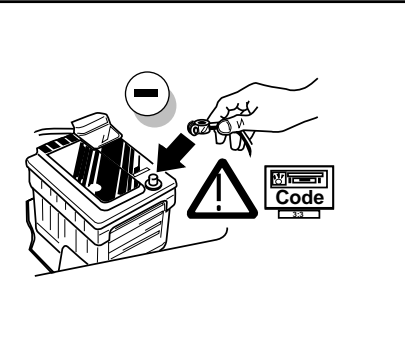
**14****15****ROUTING****16****11****12****17****18**