

Einbauanleitung Elektrosatz
Anhängervorrichtung mit 13-P Steckdose
lt. DIN/ISO Norm 11446

Instructions de montage du faisceau
électrique pour crochet d'attelage
conforme à la norme
DIN/ISO 11446 prise 13-P

Fitting instructions electric wiringkit
towbar with 13-P socket up to
DIN/ISO norm 11446

Montage-handleiding elektrokabelset voor
trekhaak met 13-P contactdoos
vlgs. DIN/ISO norm 11446

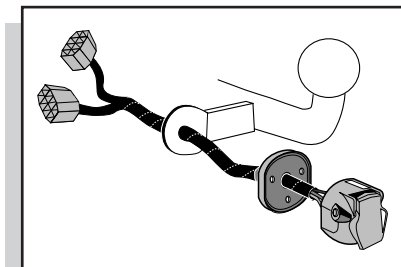

MITSUBISHI PAJERO PININ / MONTERO IO

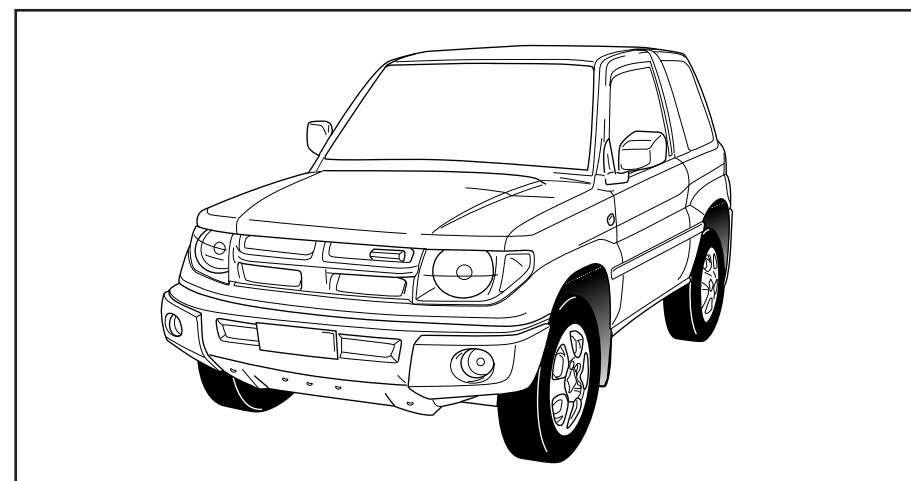

Bestel Nr.: MT-011-HL

* Teilliste

* Liste de pieces

* Part list

* Onderdelenlijst

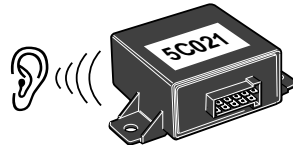
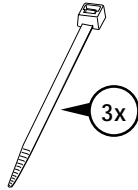
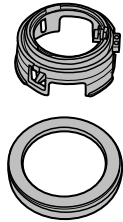
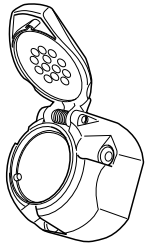
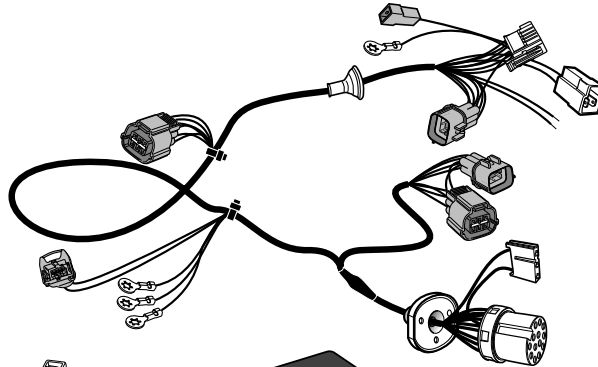
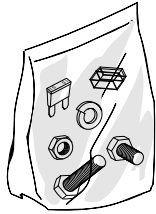
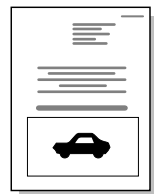
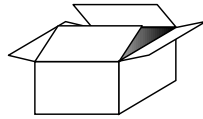

Orange Orange
Orange Orange

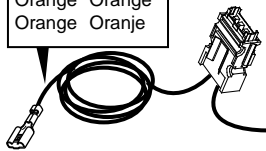

5C021

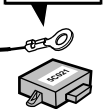

+30

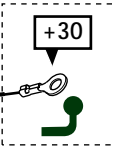

Braun/Weiß Maron/Blanc
Brown/White Bruin/Wit

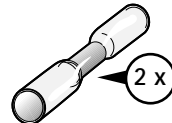
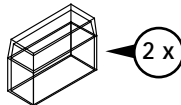
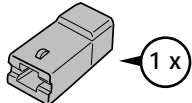
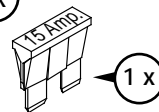
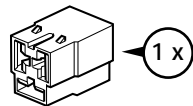
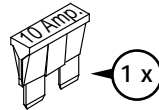
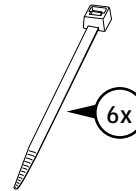
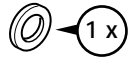
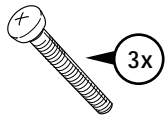

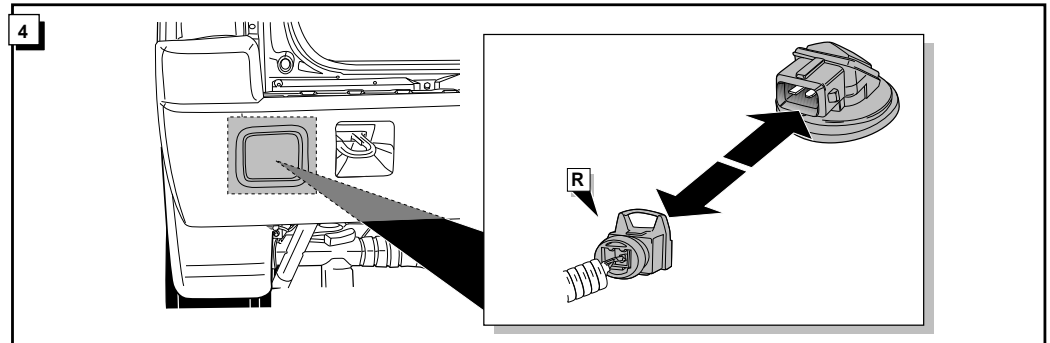
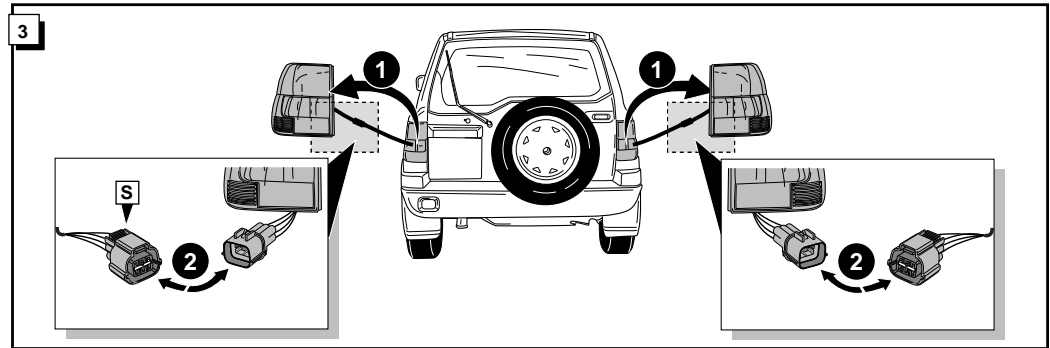
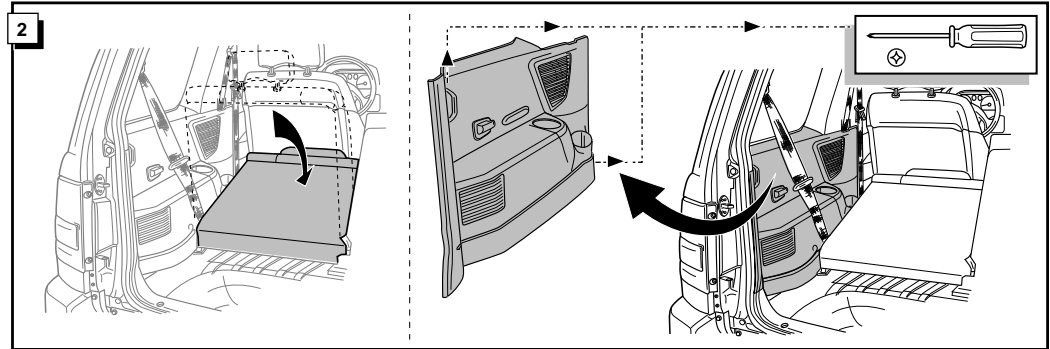
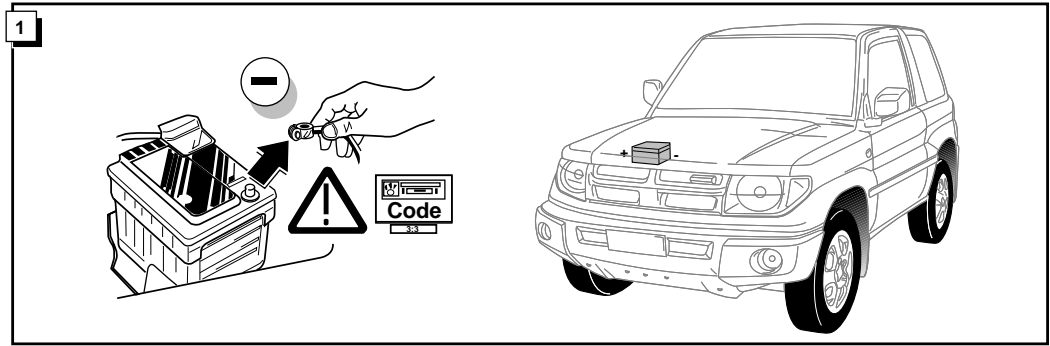

5

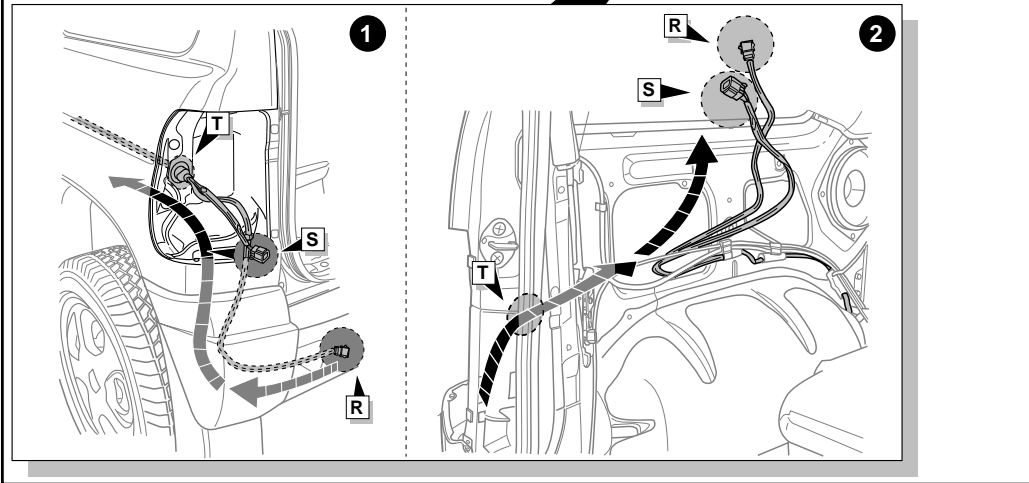
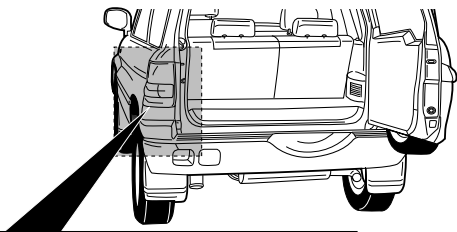

INFO

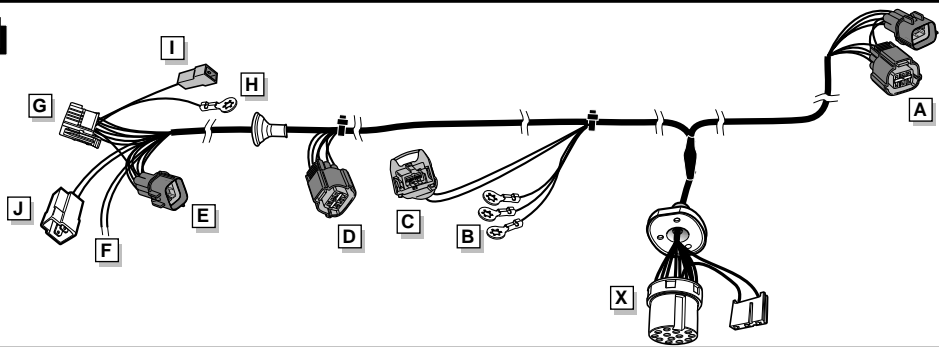

ROUTING

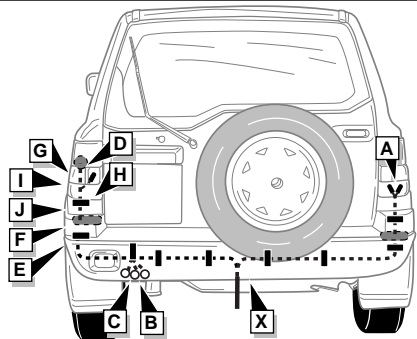

TROUBLE SHOOTING

28

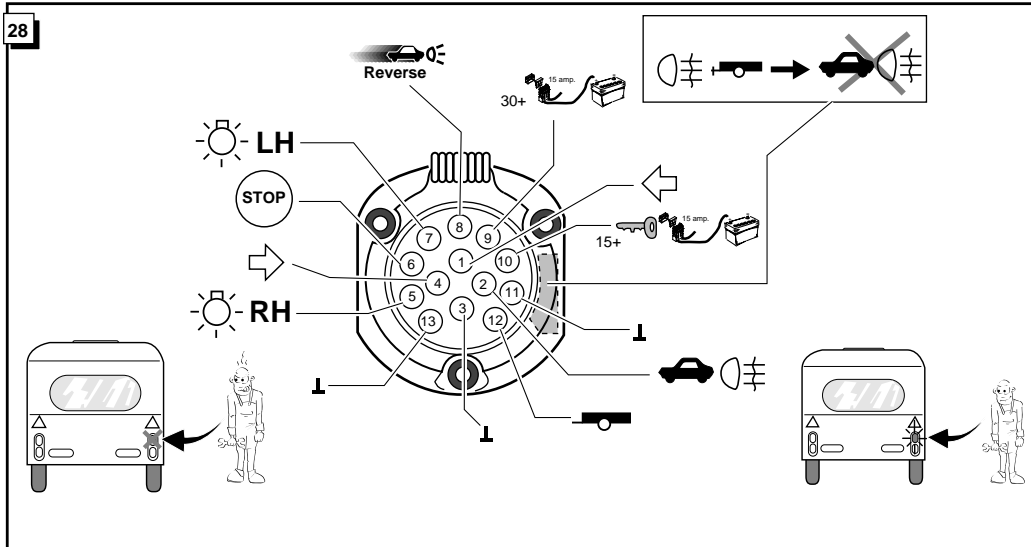

INFO Anschluß Steckdose / Connection de la prise / Socket connection / Contactdoos aansluiting

DIN/ISO 11446		(D)	(F)	(GB)	(NL)
←	1/L	gelb	jaune	yellow	geel
→	2	blau	bleu	blue	blauw
↔	2a	grau	gris	grey	grijs
⊥	1-8	weiß	blanc	white	wit
→	4/R	grün	vert	green	groen
☀	5/58-R	braun	marron	brown	bruin
STOP	6/54	rot	rouge	red	rood
☀	7/58-L	schwarz	noir	black	zwart
↔	8	schwarz/rot	noir/rouge	black/red	zwart/rood
30+ ↔	9	braun/weiß	marron/blanc	brown/white	bruin/wit
15+ ↔	10	rot	rouge	red	rood
⊥	11	weiß	blanc	white	wit
⊥	12	rot/blau	rouge/bleu	red/blue	rood/blauw
⊥	13	weiß	blanc	white	wit

6

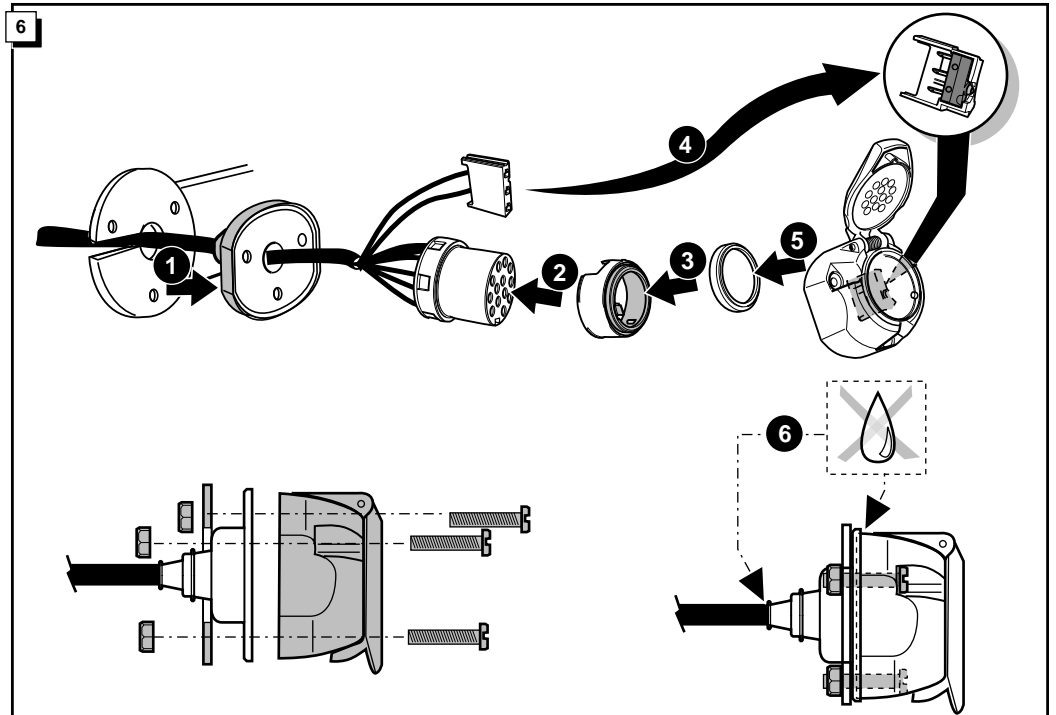

7

Einbaurichtung
 Direction de montage
 Assembling direction
 Montagerichtung

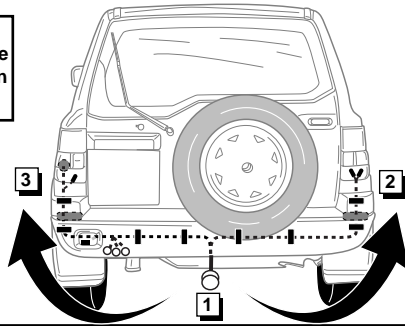

INFO

Das rote Kabel in diesem Steckverbinder ist für Ladeleitung plus für Batterie Anhänger (15+, max. 15 Amp.)

Le fil rouge au ce connecteur est pour alimentation par contact (15+, max. 15 amp.)

The red wire in this connector is for power supply controlled by ignition switch (15+, max. 15 amp.)

De rode draad in deze connector is voor geschakelde voeding (15+, max. 15 amp.)

8

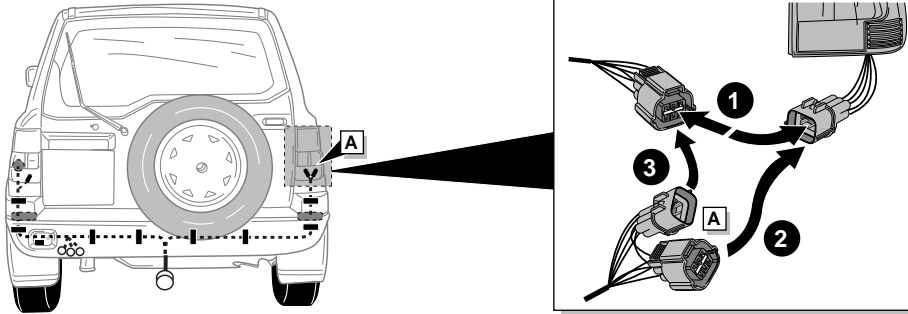

25

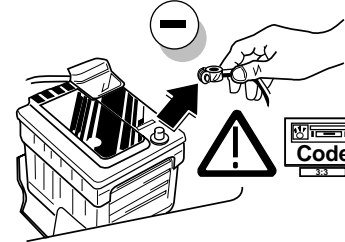

26

FUNKTIONEN KONTROLLIEREN !

CONTRÔLER LES FONCTIONS !

CHECK FUNCTIONS !

CONTROLEER FUNCTIES !

9

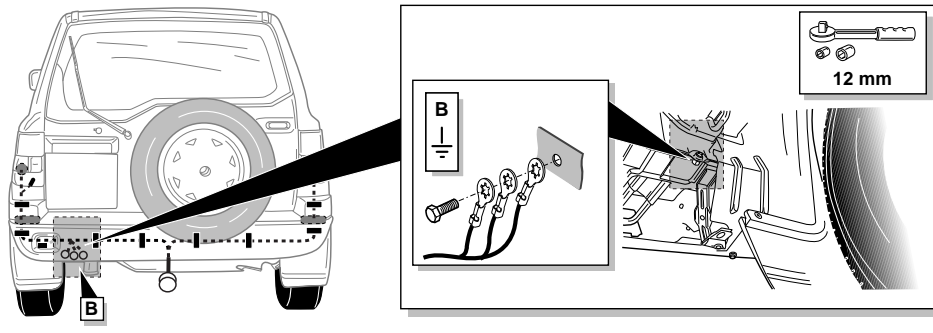

27

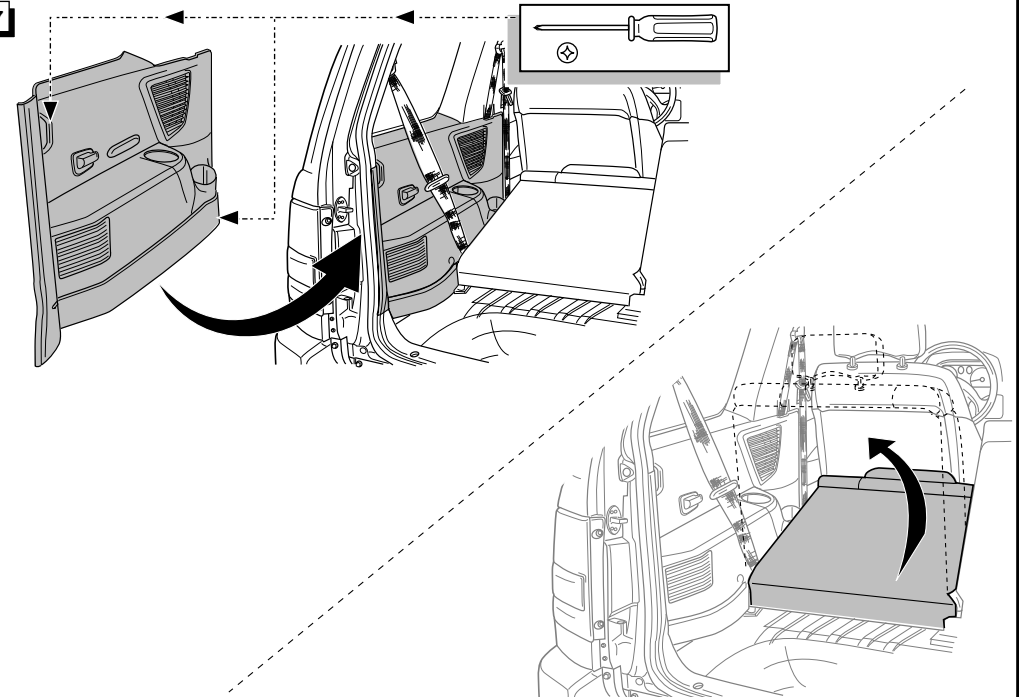

10

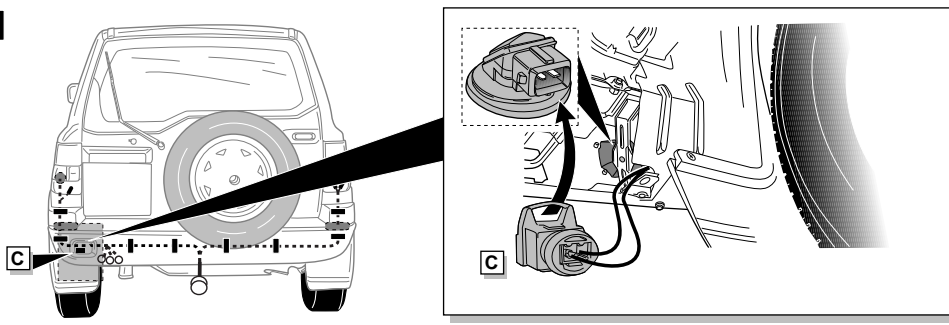

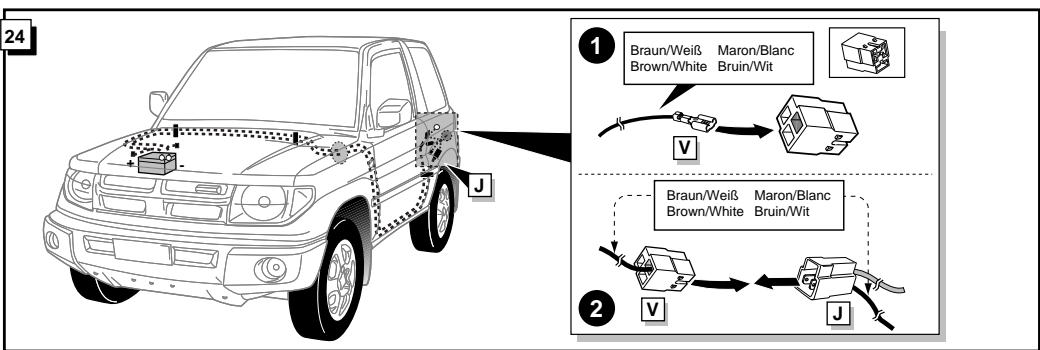
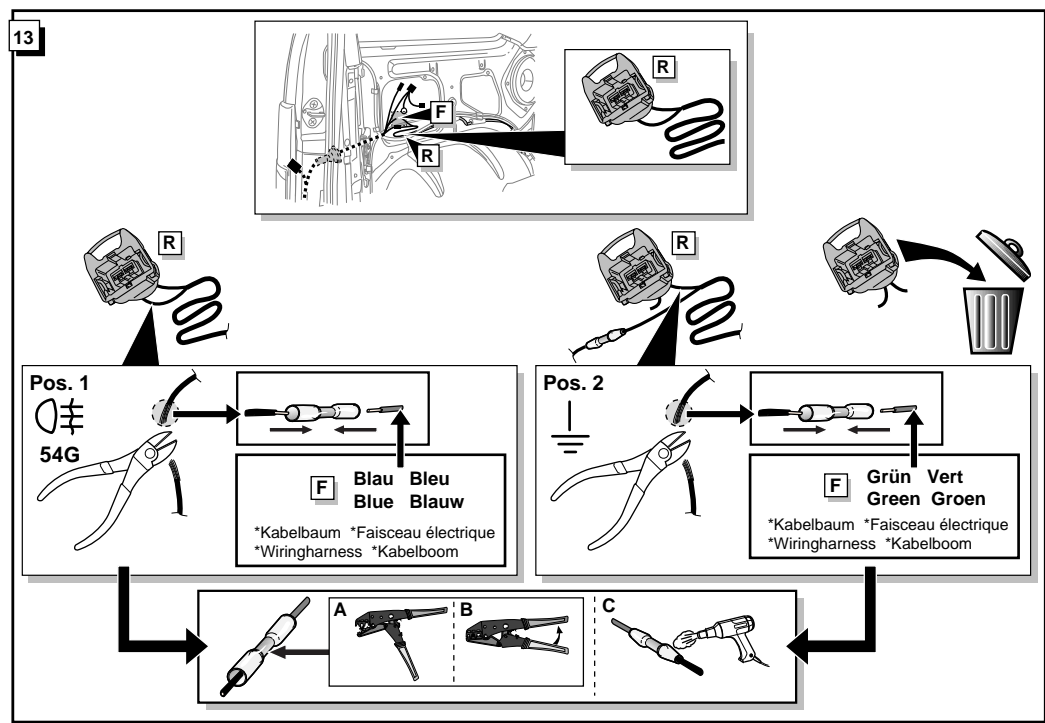
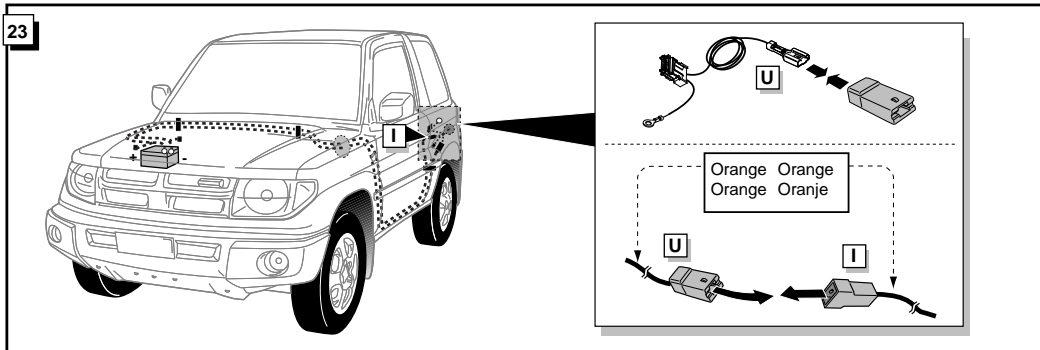
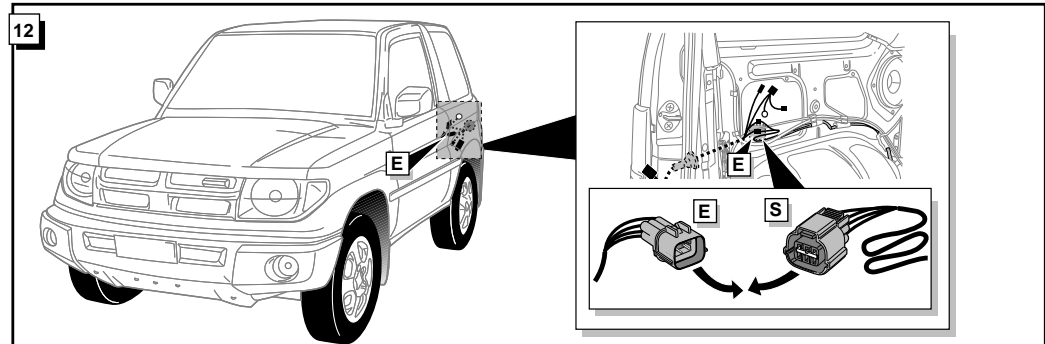
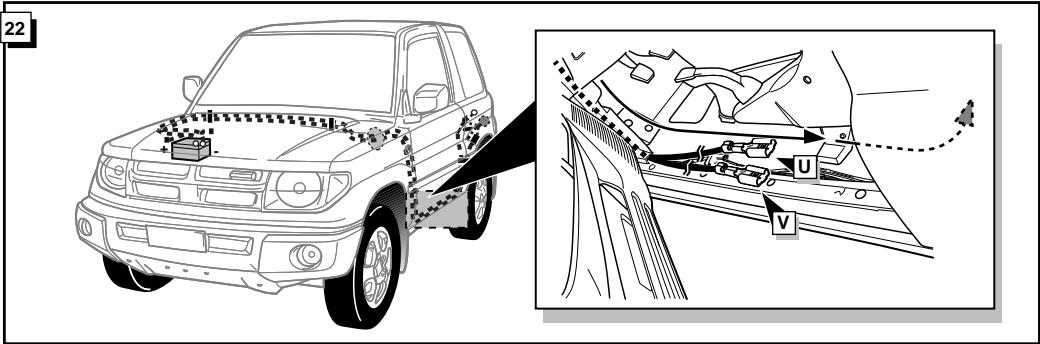
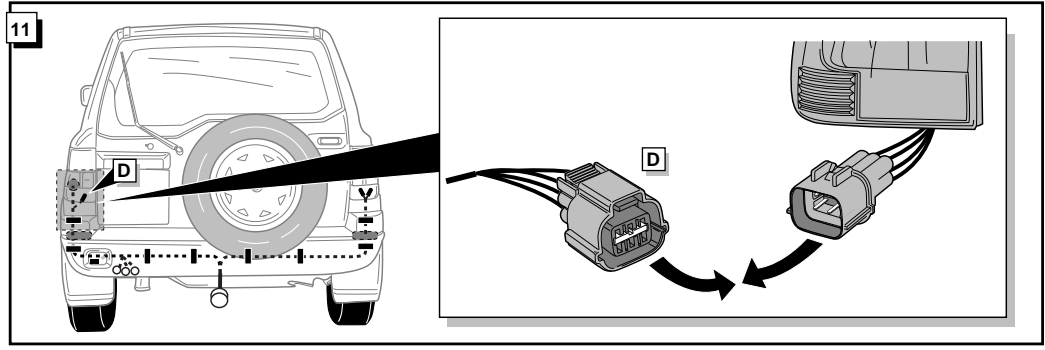
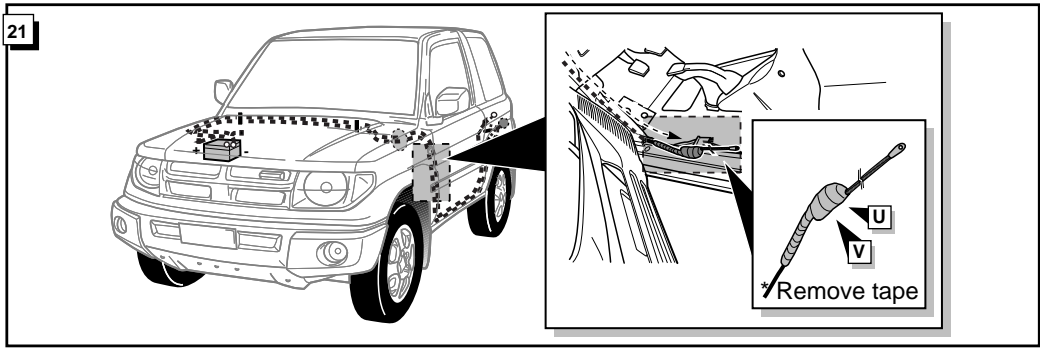

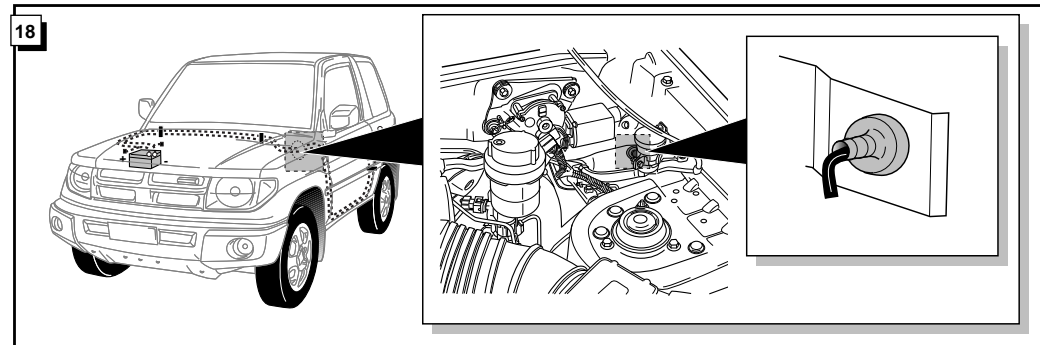
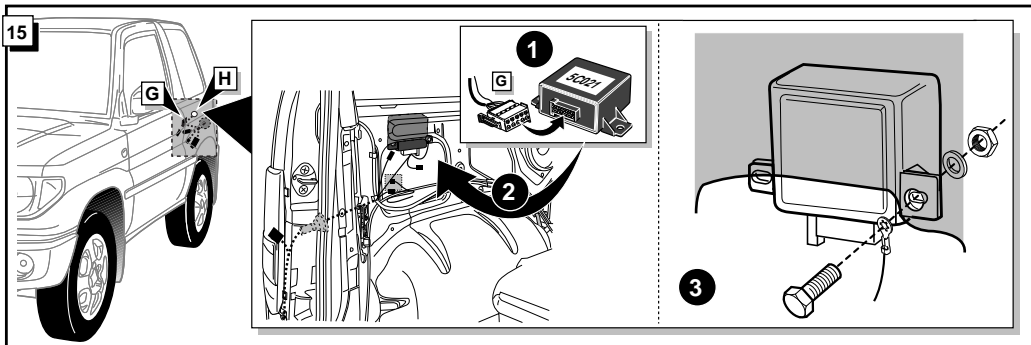
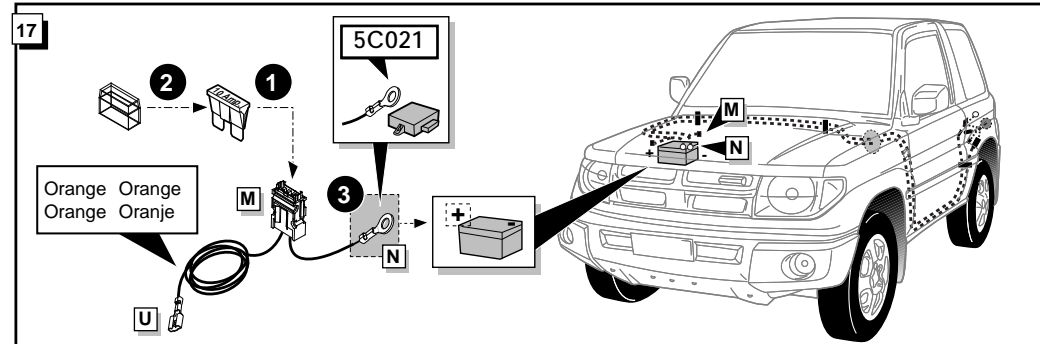
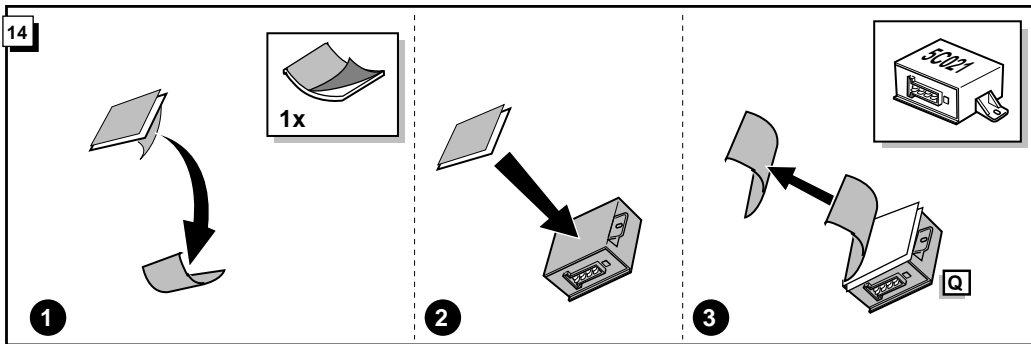

ROUTING

