

No More Costly Nissan X-Trail Repairs!

Replace MEYLE-HD axle support bushings separately and save money

Due to insufficient rubber bonding, the inner sleeve of the original Nissan X-Trail axle support bushing can become loose – a major annoyance to car owners, as the entire axle beam needs to be replaced even though only one bushing requires repair. Original-equipment bushings cannot be replaced individually, making repair a costly affair.

Now MEYLE supplies a specially designed, particularly long-lived HD Nissan X-Trail axle support bushing. And the best thing is: MEYLE-HD bushings are available separately. With the MEYLE repair solution,

a worn out OE bushing can be changed individually offering considerable time and cost benefits, as the cumbersome replacement of the entire axle beam is finally a thing of the past.

The re-engineered and technically superior MEYLE-HD support bushing features a new material design and a convexly contoured inner sleeve making the MEYLE part very robust and durable. The bushings can be ordered separately or as a kit including four bushings for the entire axle beam.

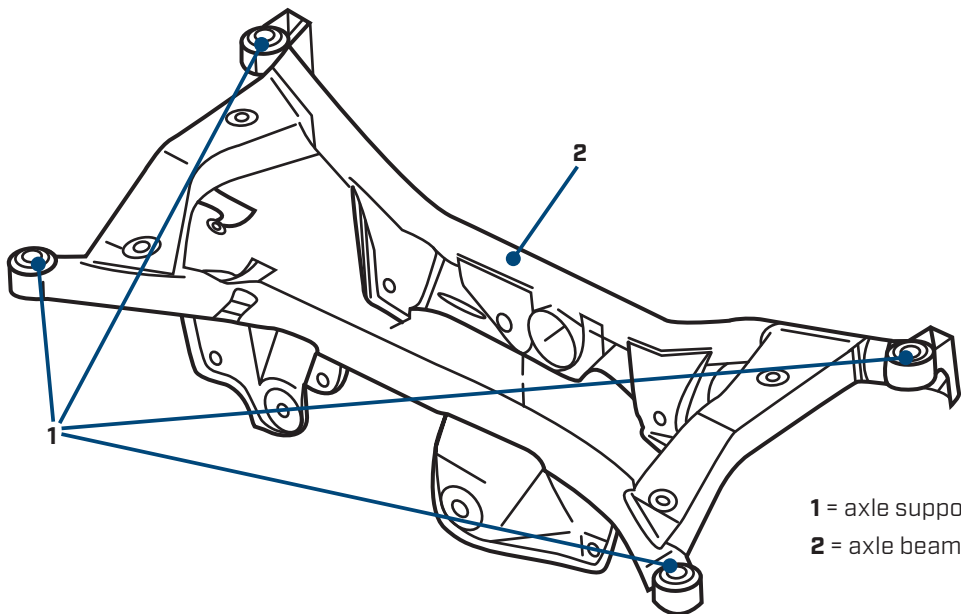

1 = axle support bushings
2 = axle beam



MEYLE-Nr.: 36-14 710 0000/HD



MEYLE-Nr.: 36-14 710 0001/HD