

**Einbauanleitung Elektrosatz
Anhängervorrichtung mit 12-N Steckdose
lt. DIN/ISO Norm 1724**

**Instructions de montage du faisceau
électrique pour crochet d'attelage
conforme à la norme
DIN/ISO 1724 prise 12-N**

**Fitting instructions electric wiringkit
towbar with 12-N socket up to
DIN/ISO norm 1724**

**Montage-handleiding elektrokabelset voor
trekhaak met 12-N contactdoos
vlg. DIN/ISO norm 1724**

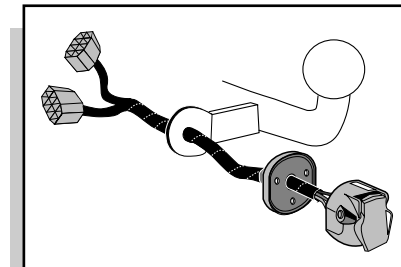

Renault Twingo 1993-

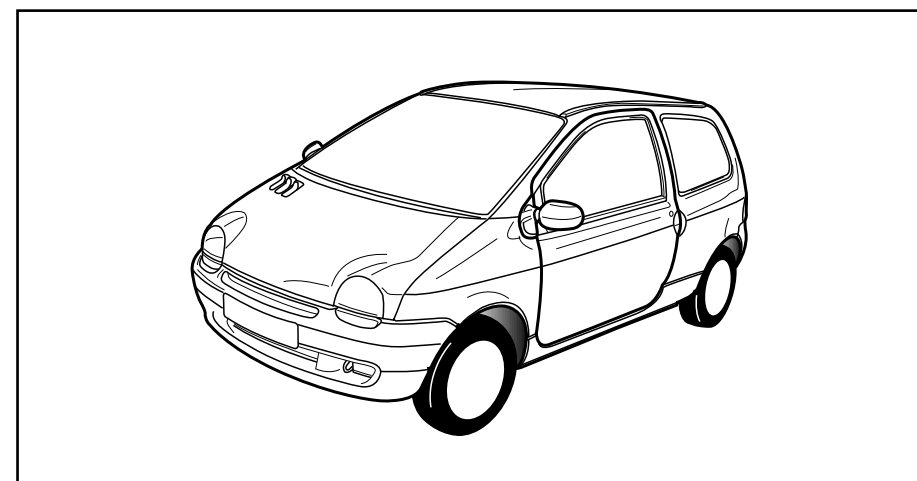

Bestel Nr.: REN-009-B

* Teilliste

* Liste de pieces

* Part list

* Onderdelenlijst

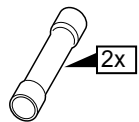
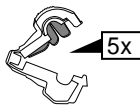
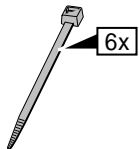
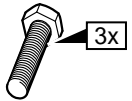
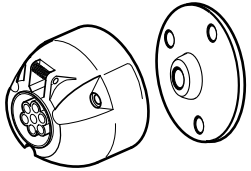
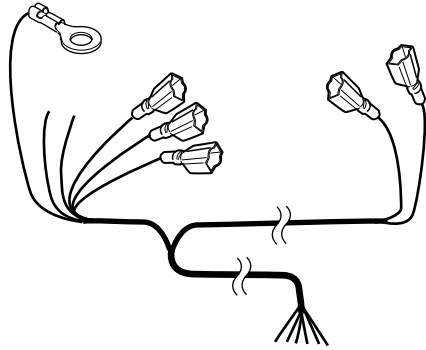
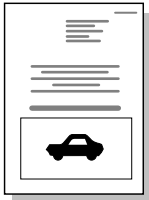
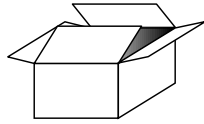

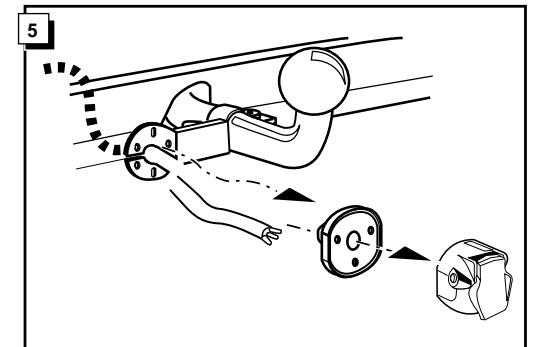
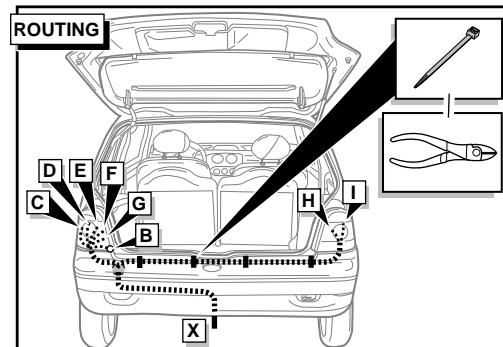
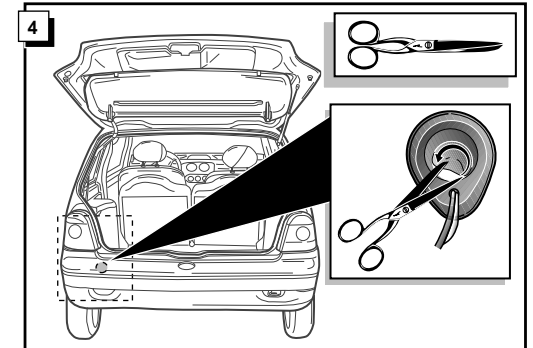
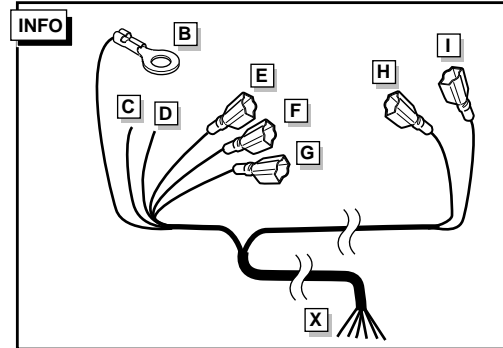
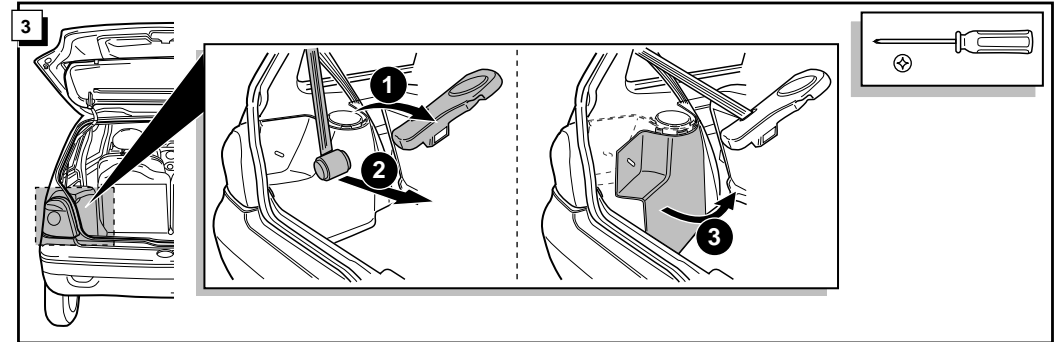
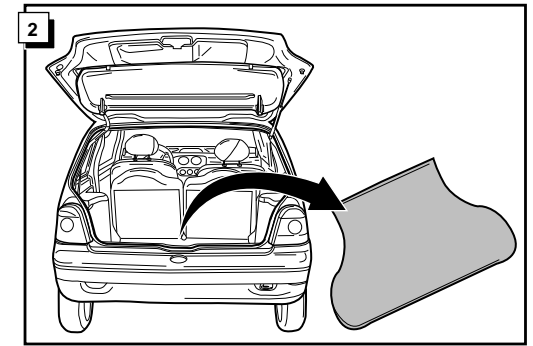
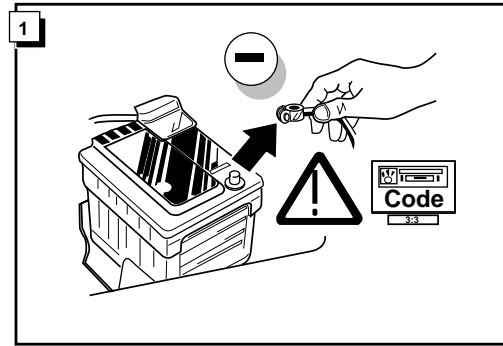

6 1

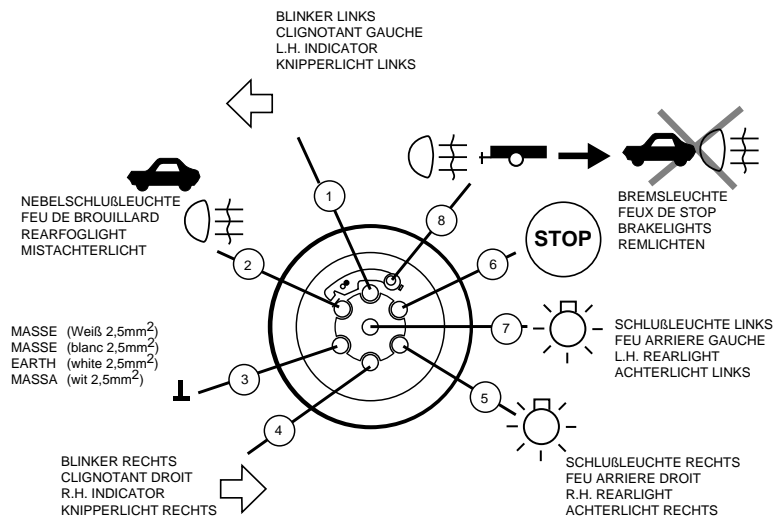

	D	FR	GB	NL
1 = L	GELB	JAUNE	YELLOW	GEEL
2 = 54-G	BLAU	BLEU	BLUE	BLAUW
3 = 31 2,5mm ²	WEIß	BLANC	WHITE	WIT
4 = R	GRÜN	VERT	GREEN	GROEN
5 = 58-R	BRAUN	MARRON	BROWN	BRUIN
6 = 54	ROT	ROUGE	RED	ROOD
7 = 58-L	SCHWARZ	NOIR	BLACK	ZWART
8 = 58-B	GRAU	GRIS	GREY	GRIJS

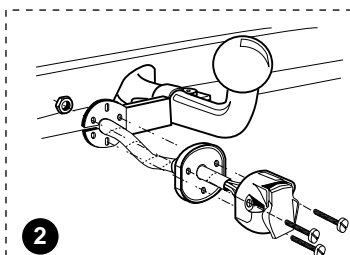

7

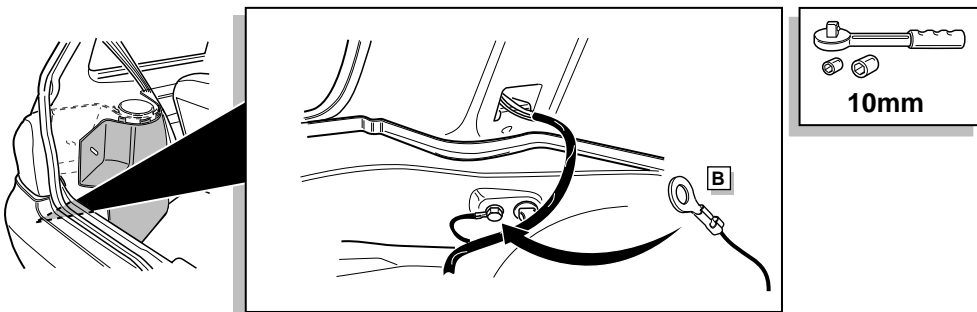

13

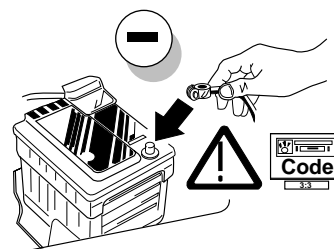

14

! FUNKTIONEN KONTROLIEREN !
! CONTRÔLER LES FONCTIONS !
! CHECK FUNCTIONS !
! CONTROLEER FUNCTIES !

15

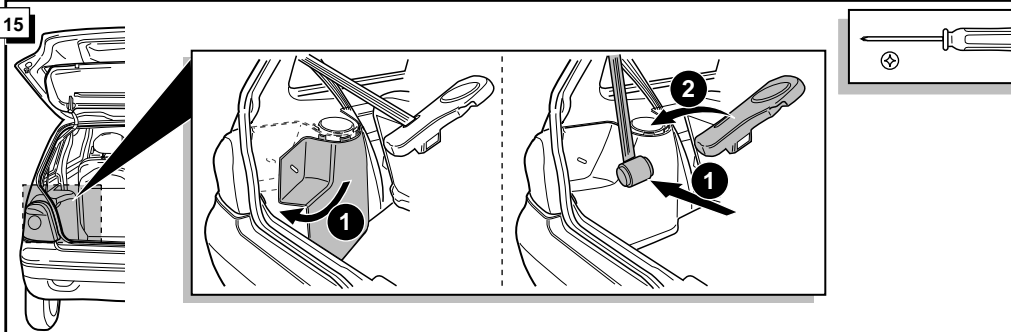

16

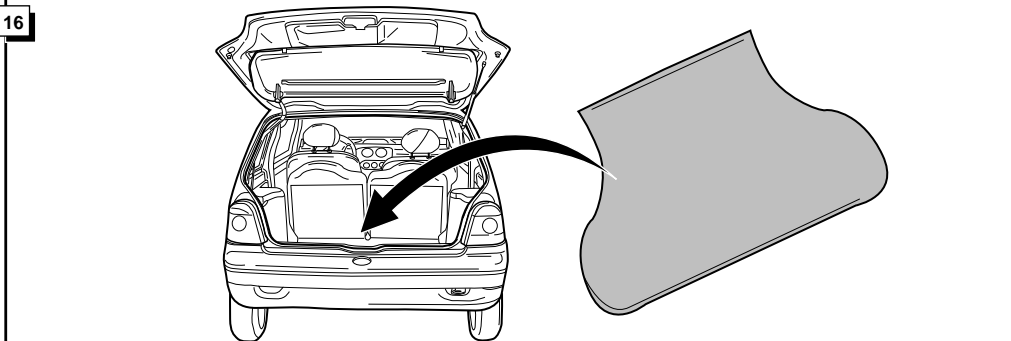

11 Twingo Phase II 1999-

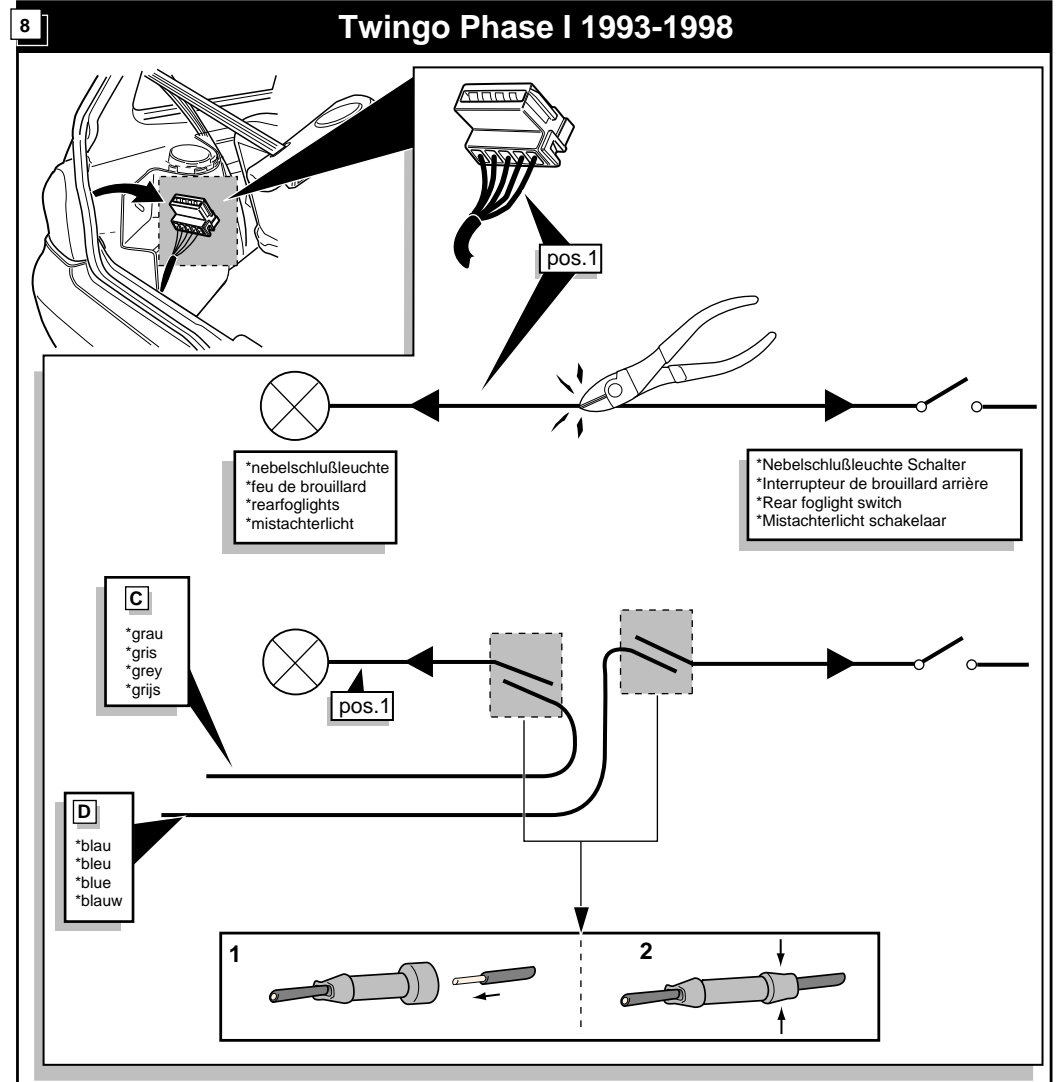
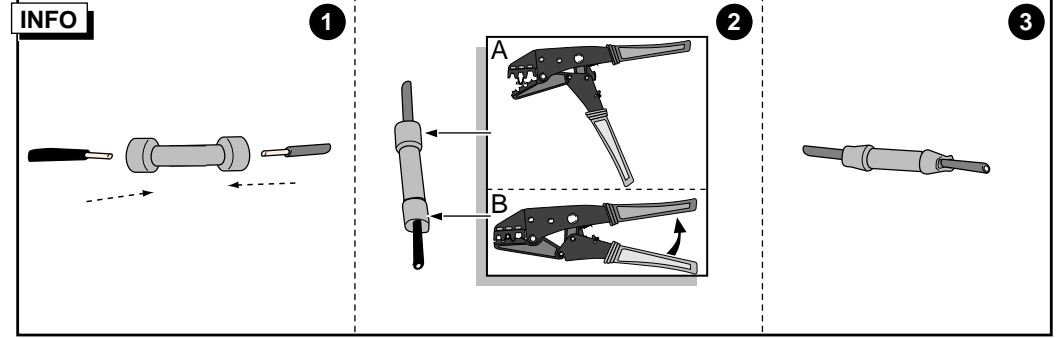
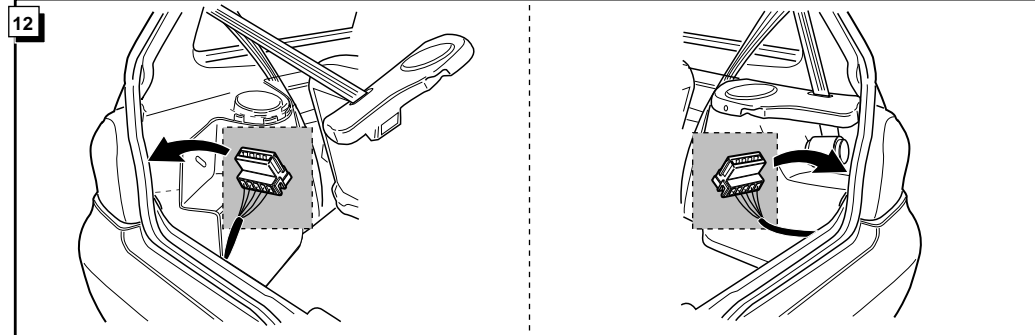
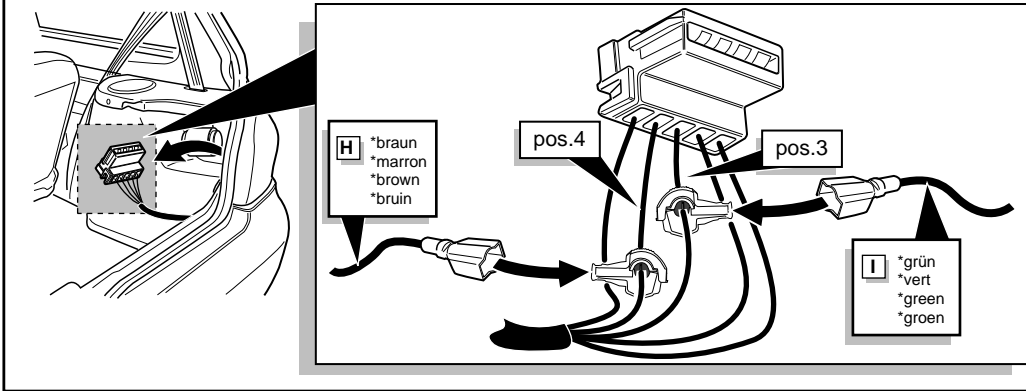
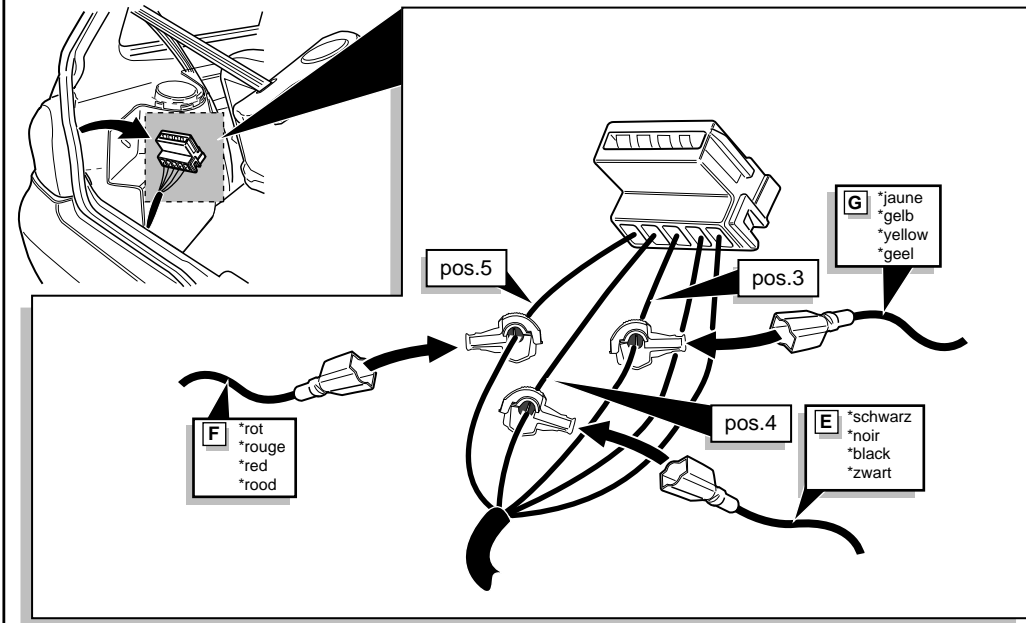

INFO

1

2

3

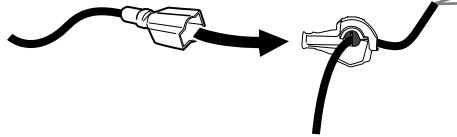
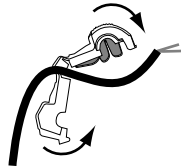
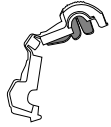

9

Twingo Phase I 1993-1998

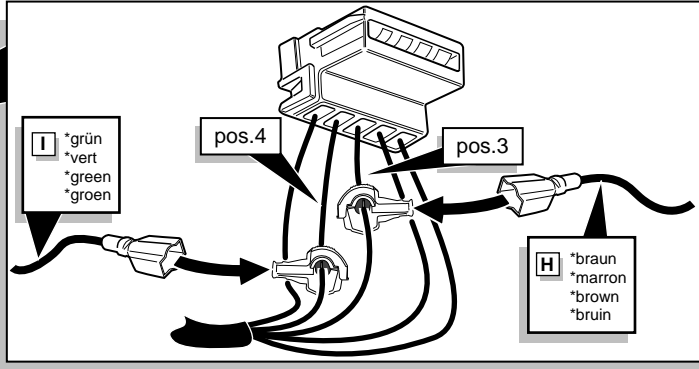
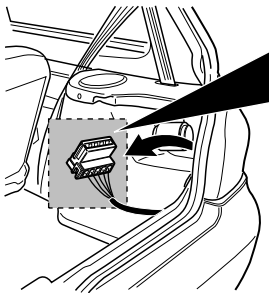
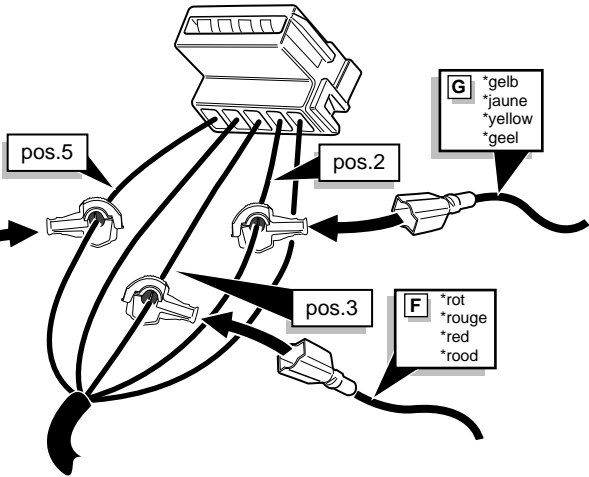
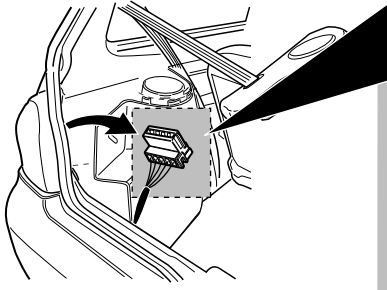

10

Twingo Phase II 1999-



pos.2

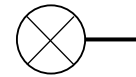
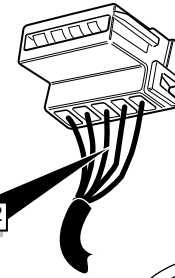

*nebelschlußleuchte
*feu de brouillard
*rearfoglights
*mistachterlicht

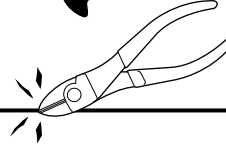

*Nebelschlußleuchte Schalter
*Interrupteur de brouillard arrière
*Rear foglight switch
*Mistachterlicht schakelaar

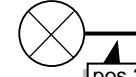

pos.2

C
*grau
*gris
*grey
*grijs

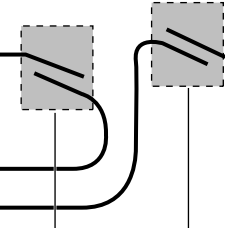

D
*blau
*bleu
*blue
*blauw

1

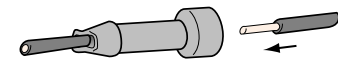

2

