

Fitting instructions

Make: Dodge

Caliber; 2006->

Type: 4526

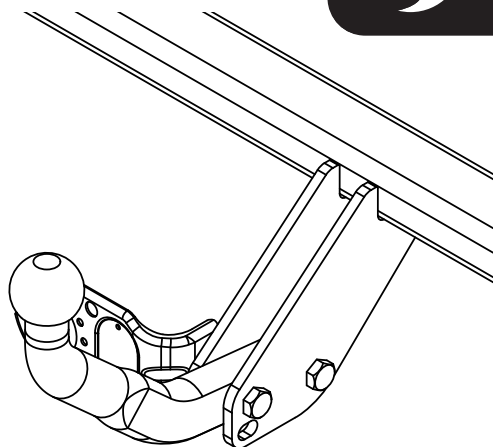





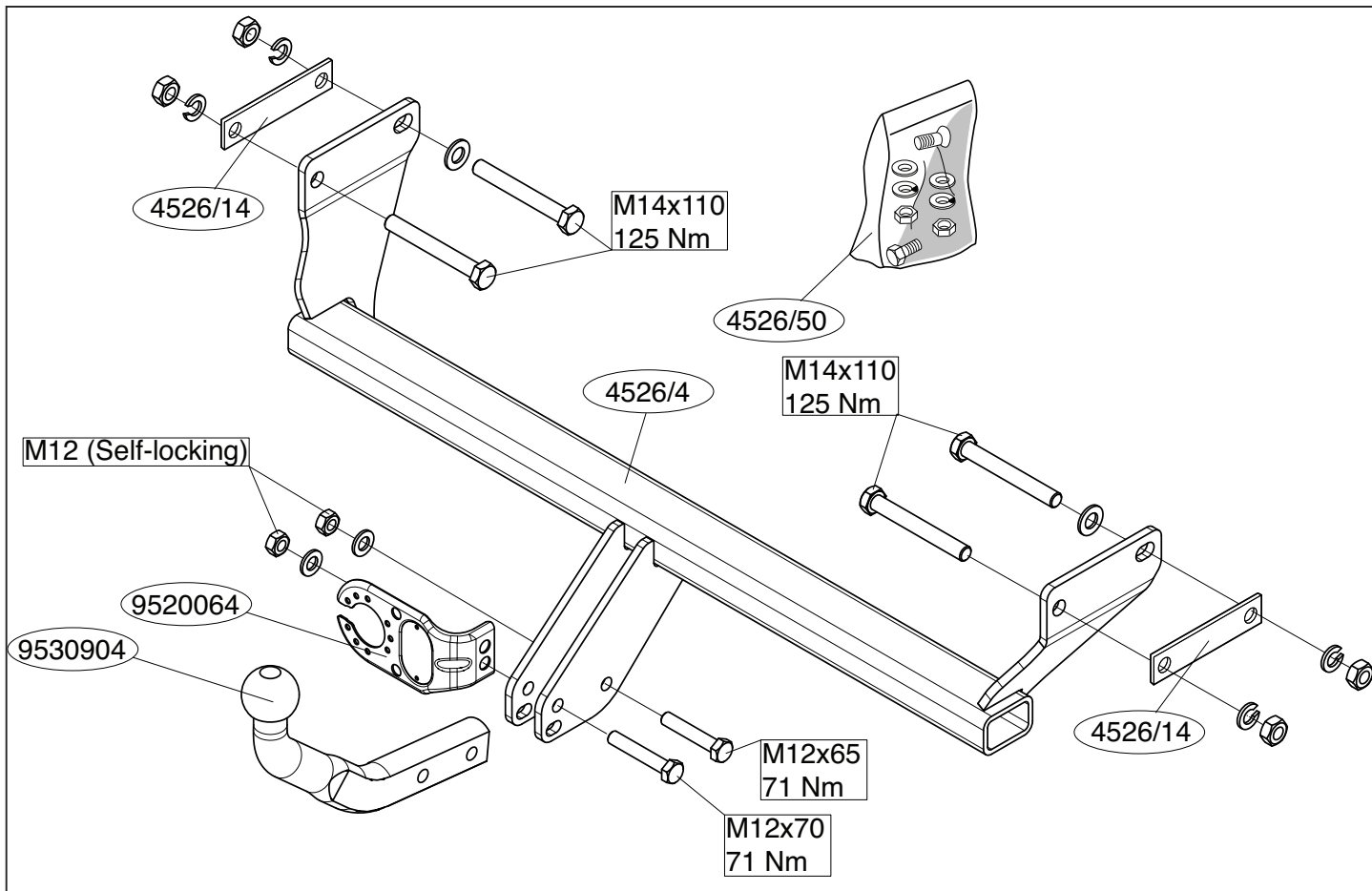

- NL Montagehandleiding
- GB Fitting instructions
- D Montageanleitung
- F Instructions de montage
- S Monteringsanvisningar
- DK Montagevejledning
- E Instrucciones de montaje
- I Istruzioni per il montaggio
- PL Instrukcja montażu
- SF Asennusohjeet
- CZ Pokyny k montáži
- H Szerelési útmutató
- RUS Руководство для монтажа

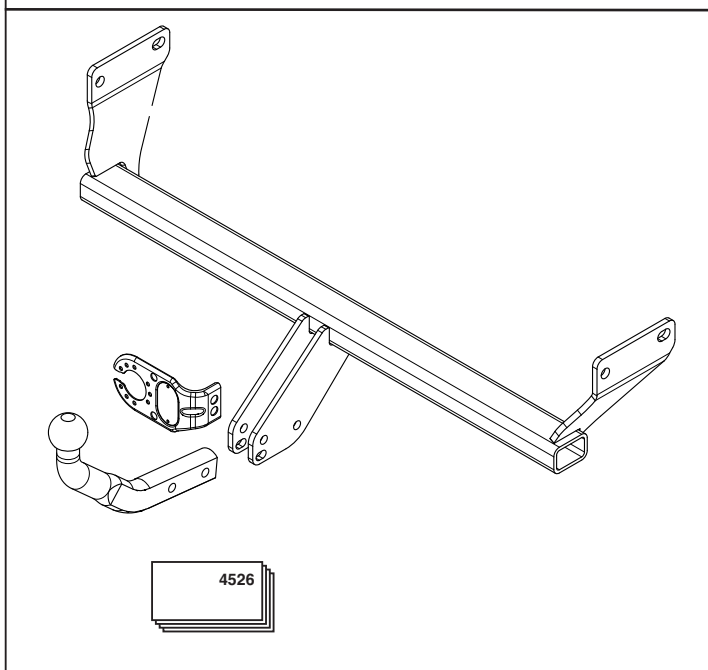
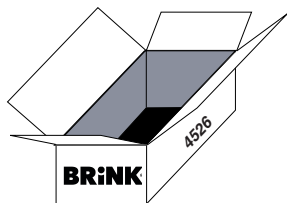
BRINK®

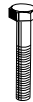
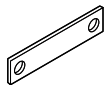
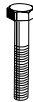
Your perfect fit
brink.eu

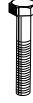



-  (4x) M14x110
-  (2x) Contra
-  (1x) M12x70
-  (4x) M14
-  (1x) M12x65
-  (2x) M12
-  (2x) M14
-  (2x) M12 (self-locking)
-  (4x) M14

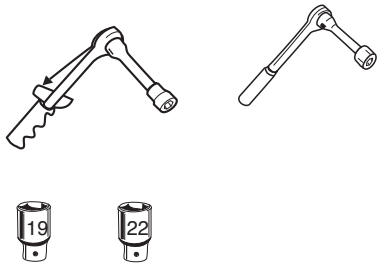

Couplingsclass: A50-X

euro tested

Approved

e11 00-5510

94/20/EC

D-Value : 8,4 kN

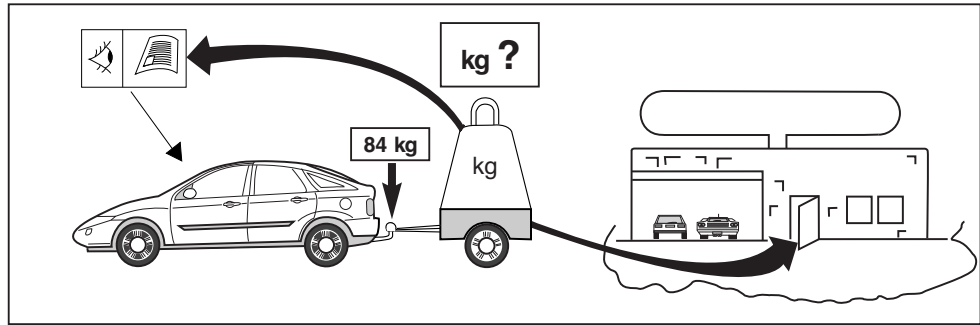
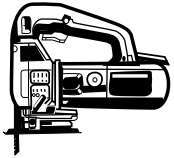

8.8

8

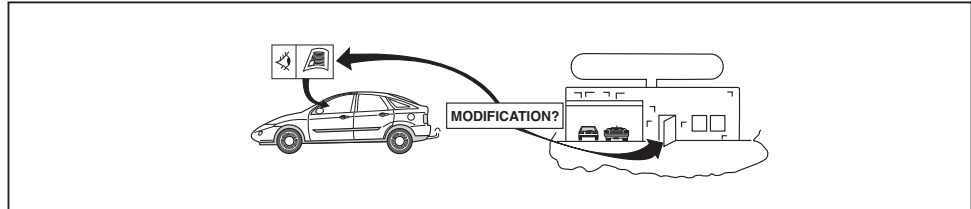

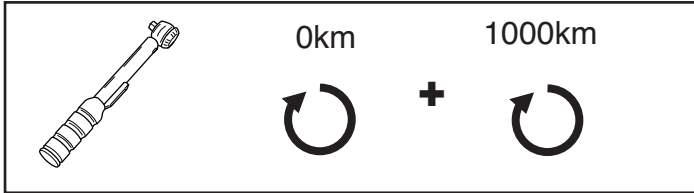

NOTE:

* Should this installation process entail the cutting of the bumper – conformation **MUST** be obtained by the installation engineer of the customer's acceptance prior to completion. Brink Towing Systems do not accept responsibility for any matters arising as a result of this miscommunication.

All measurements are in mm!

HINWEISE:

* Die für das Fahrzeug zugelassene Anhängelast ist den Fahrzeug Unterlagen zu entnehmen. Bei Änderungen des Fahrzeuggewichtes muß die höchstzulässige Anhängelast gegebenenfalls aus dem D-Wert nachgerechnet werden.

Auskunft hierüber kann Ihr Fachhändler oder der TÜV geben.

* Elektrische Anlage gemäß StVZO anbringen.

