

Montageanleitung

LED Universal Leuchte

Mounting instructions

LED Universal light

Instructions de montage

LED Universel lampe

Monteringsanvisning

LED Universal ljus

Montagehandleiding

LED Universeel licht

Instrucciones de montaje

LED Universal lámpara

Istruzioni di montaggio

LED Universale fanale

Asennusohjeet

LED Yleismallinen valaisin



Lieferumfang
Kit includes
Fourniture

Leveransomfatning
Inhoud set
Volumen del suministro

Dotazione die fornitura
Osaluuttelo

2SD 343 910-01.

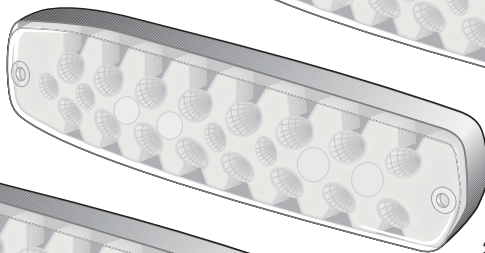
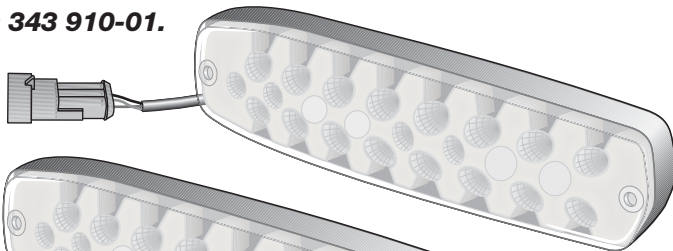

2SD 343 910-02.

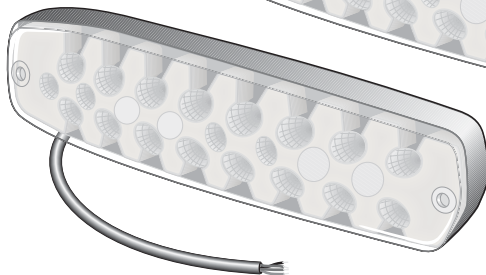

2SD 343 910-00.

Benötigt Werkzeug
Tools required
Outillage nécessaire

Nödvändiga verktyg
Noodzakelijk gereedschap
Herramientas necesarias

Utensili necessari
Tarvittavat työkalut

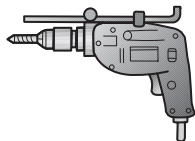
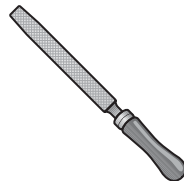
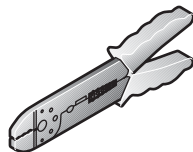
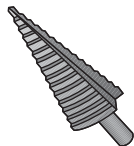

3 mm
8 mm



TORX 20

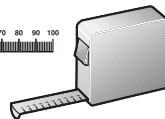
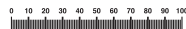

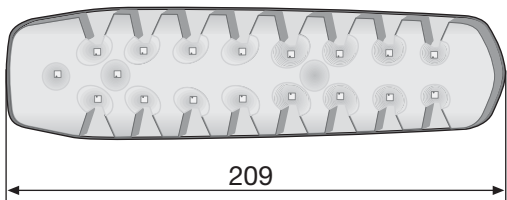

A 2SD 343 910-00.

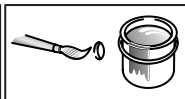
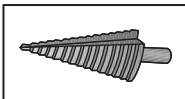
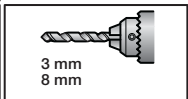
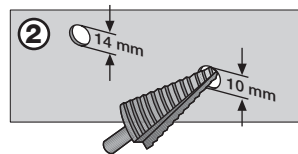
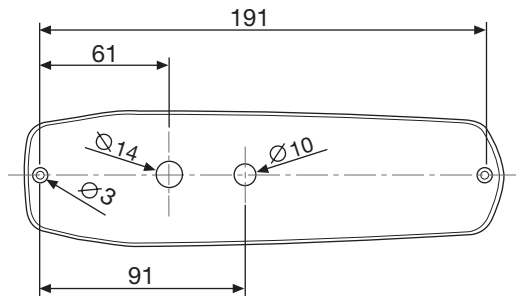
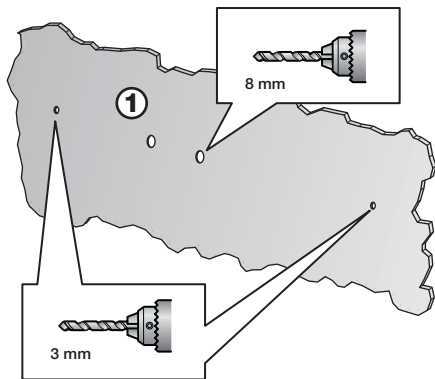

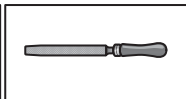
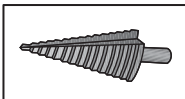
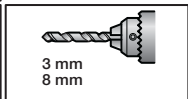
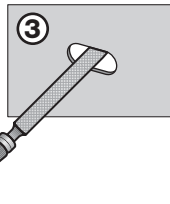
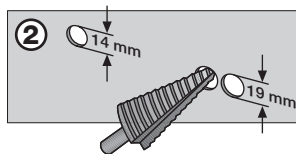
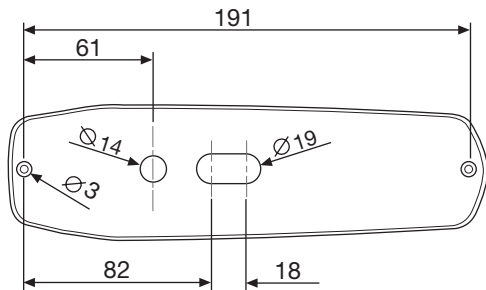
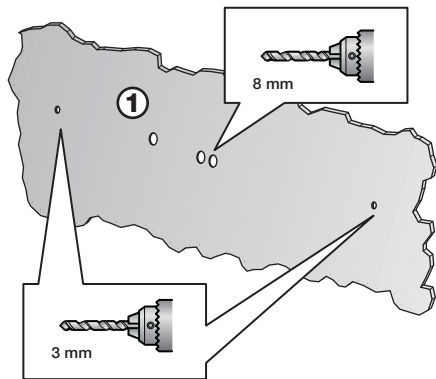
B**2SD 343 910-01.**

C 2SD 343 910-02.

7

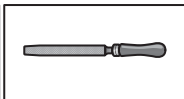
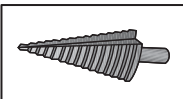
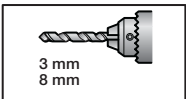
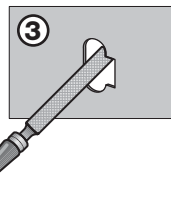
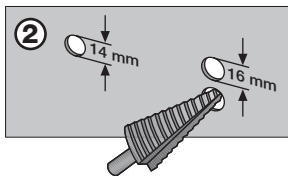
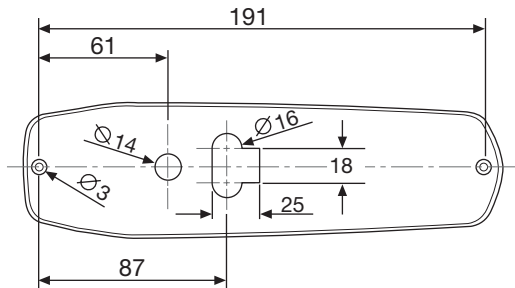
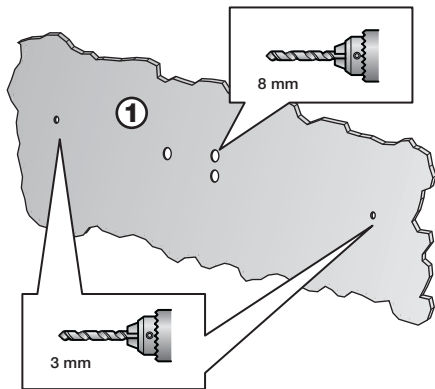

8KW 744 808-801

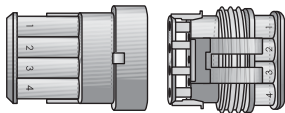

Nicht im Lieferumfang enthalten
Not included with kit
Non fornita
Ingår ej i leveransen
Worden niet meegeleverd
No se incluyen en el suministro
Non in dotazione
Eivät kuulu toimitukseen

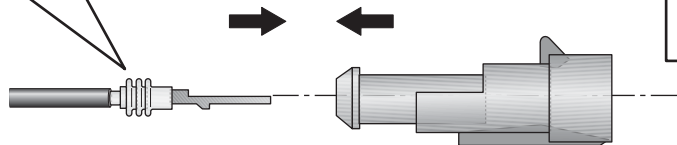
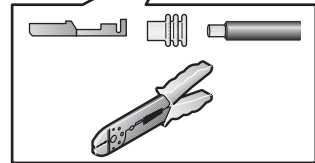
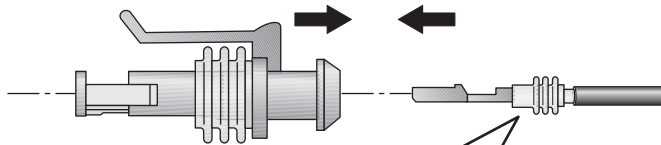
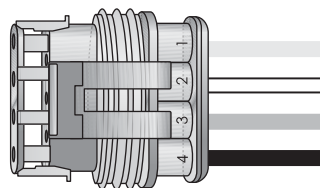
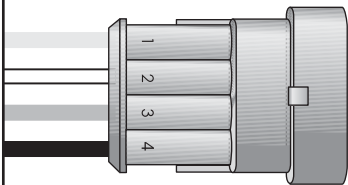
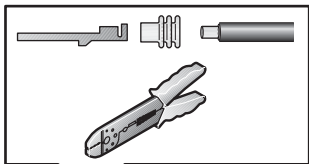

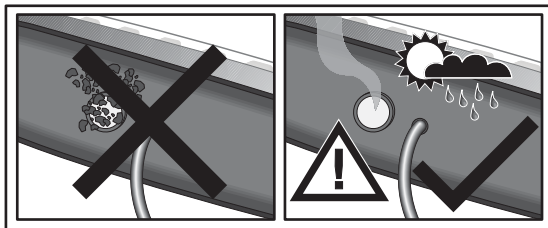

2x
PT 3,0 x 30

Nicht im Lieferumfang enthalten
Non included with kit
Non fournis
Ingår ej i leveransen
Worden niet meegeleverd
No se incluyen en el suministro
Non in dotazione
Eivät kuulu toimitukseen

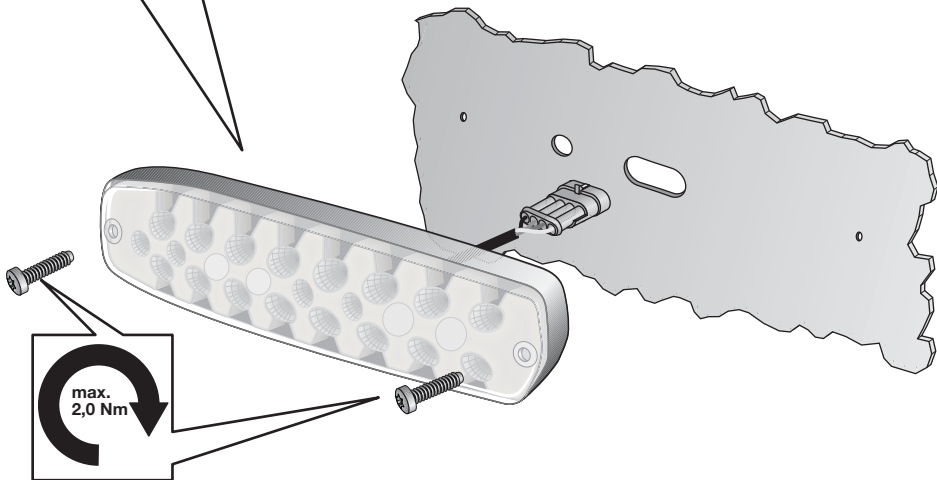

DE	1. Gelb	= (+) Blinklicht
	2. Weiss	= (-) Masse
	3. Rot	= (+) Bremslicht
	4. Schwarz	= (+) Schlusslicht

NL	1. Geel	= (+) Richtingaanwijzerlicht
	2. Wit	= (-) Massa
	3. Rood	= (+) Remlicht
	4. Zwart	= (+) Achterlicht

EN	1. Yellow	= (+) Turn Indicator
	2. White	= (-) Ground
	3. Red	= (+) Stop light
	4. Black	= (+) Tail light

ES	1. Amarillo	= (+) Luz del indicadode de direccion
	2. Blanco	= (-) Masa
	3. Rojo	= (+) Luz de paro
	4. Negro	= (+) Luz trasera

FR	1. Jaune	= (+) Feu clignotant
	2. Blanc	= (-) Fil de masse
	3. Rouge	= (+) Feu stop
	4. Noir	= (+) Feu arriere

IT	1. Giallo	= (+) Direzione luze indicatore
	2. Bianco	= (-) Terra
	3. Rosso	= (+) Luce stop
	4. Nero	= (+) Luce di coda

SV	1. Gul	= (+) Blinkerljus
	2. Vit	= (-) Jord
	3. Röd	= (+) Bromsljus
	4. Svart	= (+) Bakljus

FI	1. Keltainen	= (+) Vilkku
	2. Valkoinen	= (-) Maa
	3. Punainen	= (+) Jarruvalo
	4. Musta	= (+) Takavallo

Technische Daten

Art.-Nr.:	2SD 343 910-00/01/02
Eingangsspannung:	9 - 32V
Stromverbrauch:	1 - 2W
Materialien:	Gehäuse: PC/ABS, Lichtscheibe: PMMA, Reflektor: PC
IP Klasse:	6K9K
Temperaturbereich:	-40°C bis + 50°C

Technical Data

Part No:	2SD 343 910-00/01/02
Input voltage:	9 - 32V
Power consumption:	1 - 2W
Materials:	Housing: PC/ABS, Lens: PMMA, Reflector: PC
IP Class:	6K9K
Temperature range:	-40°C to + 50°C

Données techniques

Référence:	2SD 343 910-00/01/02
Tension d'entrée:	9 - 32V
Consommation:	1 - 2W
Matériaux:	Boîtier: PC/ABS, Voyant: PMMA, réflecteur: PC
Classe IP:	6K9K
Plage de température:	-40°C à + 50°C

Teknisk information

Artikelnr:	2SD 343 910-00/01/02
Inspänning:	9 - 32V
Effektförbrukning:	1 - 2W
Material:	Kapa: PC/ABS, Lins: PMMA, Reflektor: PC
IP klass:	6K9K
Temperaturområde:	-40°C till + 50°C

Technische gegevens

Artikelnr:	2SD 343 910-00/01/02
Ingångsspänning	9 - 32V
Opgenomen vermogen	1 - 2W
Materialien:	Huis: PC/ABS, Lens: PMMA, Reflector: PC
IP Class:	6K9K
Temperatuurbereik:	-40°C tot + 50°C

Données techniques

N°de artículo:	2SD 343 910-00/01/02
Tensión de entrada:	9 - 32V
Consumo de corriente	1 - 2W
Materiales:	Caja: PC/ABS, Lente: PMMA, Reflector: PC
Clase IP:	6K9K
Gama de temperaturas:	-40°C a + 50°C

Dati tecnici

N. art.:	2SD 343 910-00/01/02
Tensione di ingresso Assorbimento di potenza	9 - 32V 1 - 2W
Materiali:	Scatola: PC/ABS, Lente: PMMA, Riflettore: PC
Classe IP:	6K9K
Temperatura:	-40°C a + 50°C

Tekniset tiedot

Tuotenro.:	2SD 343 910-00/01/02
Jännite: Teho:	9 - 32V 1 - 2W
Materiaalit:	Runko: PC/ABS, Lasi: PMMA, Heijastaja: PC
IP Luokka:	6K9K
Lämpötila-alue:	-40°C - + 50°C

© Hella Lighting Finland Oy,

www.hella.com

FIN 24280 Salo

460 903-46 06/08

Printed in Finland

